











S/S BOHUŠLAN

Scale : 1:45

COLOR CHART

	White
	Black
	Red 1
	Red 2
	Blue
	Gray
	Gray 2
	Green
	Gold

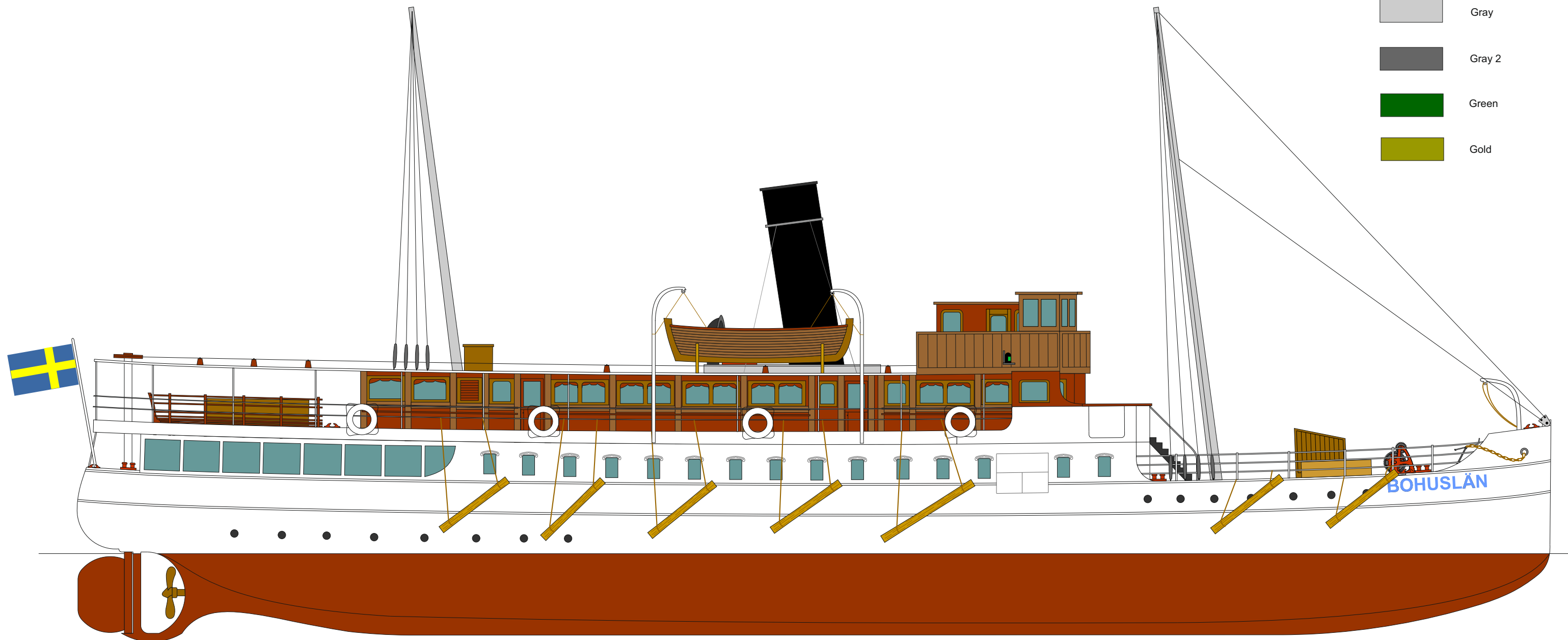

COLOR CHART

- White
- Black
- Red 1
- Red 2
- Blue
- Gray
- Gray 2
- Green

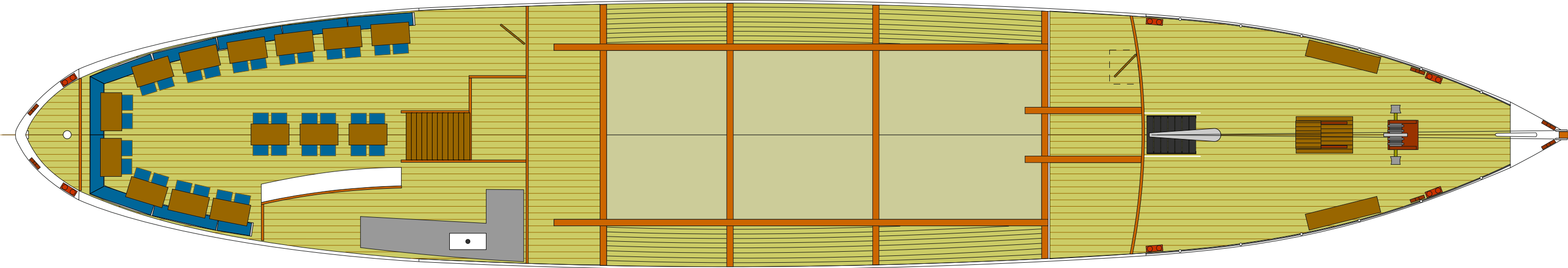
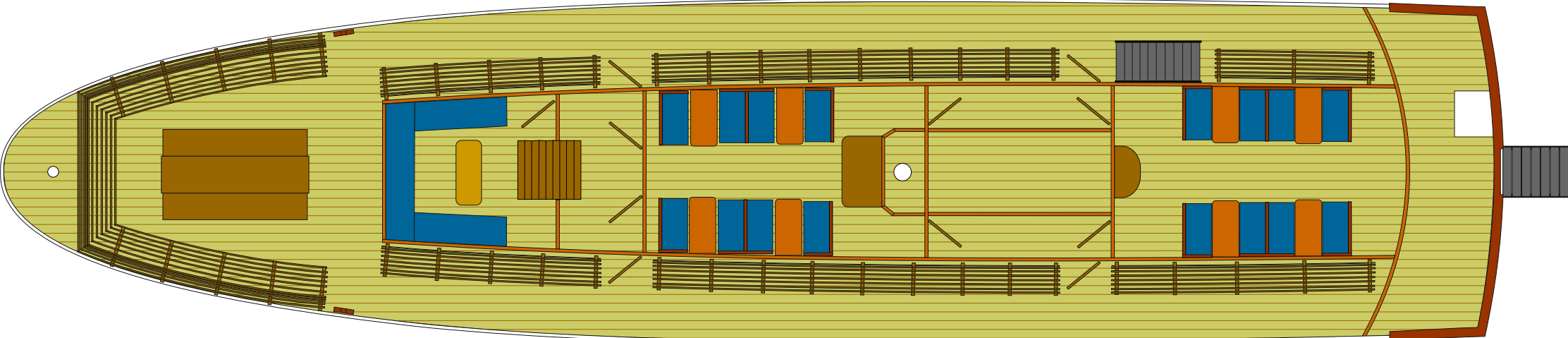
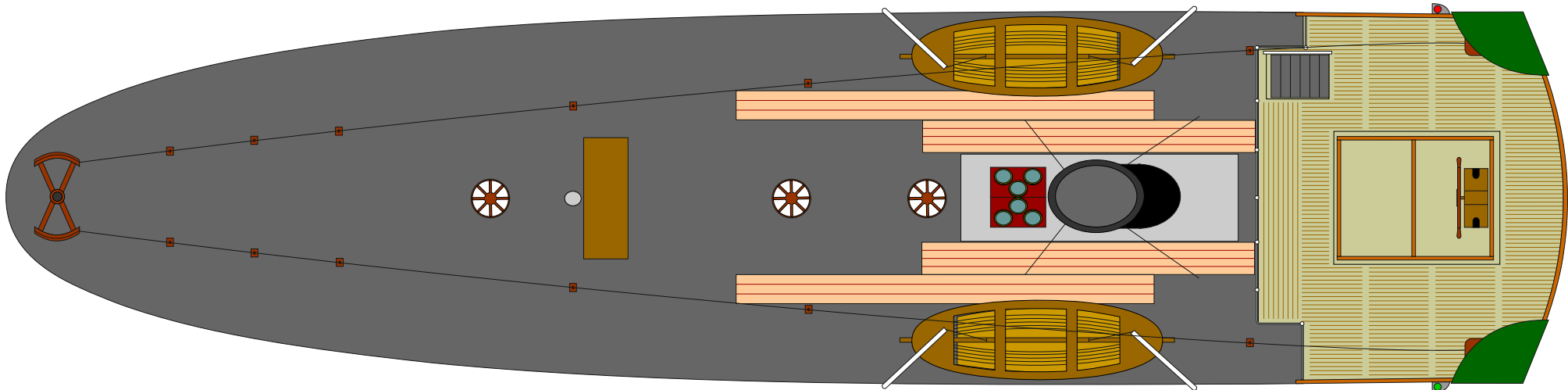

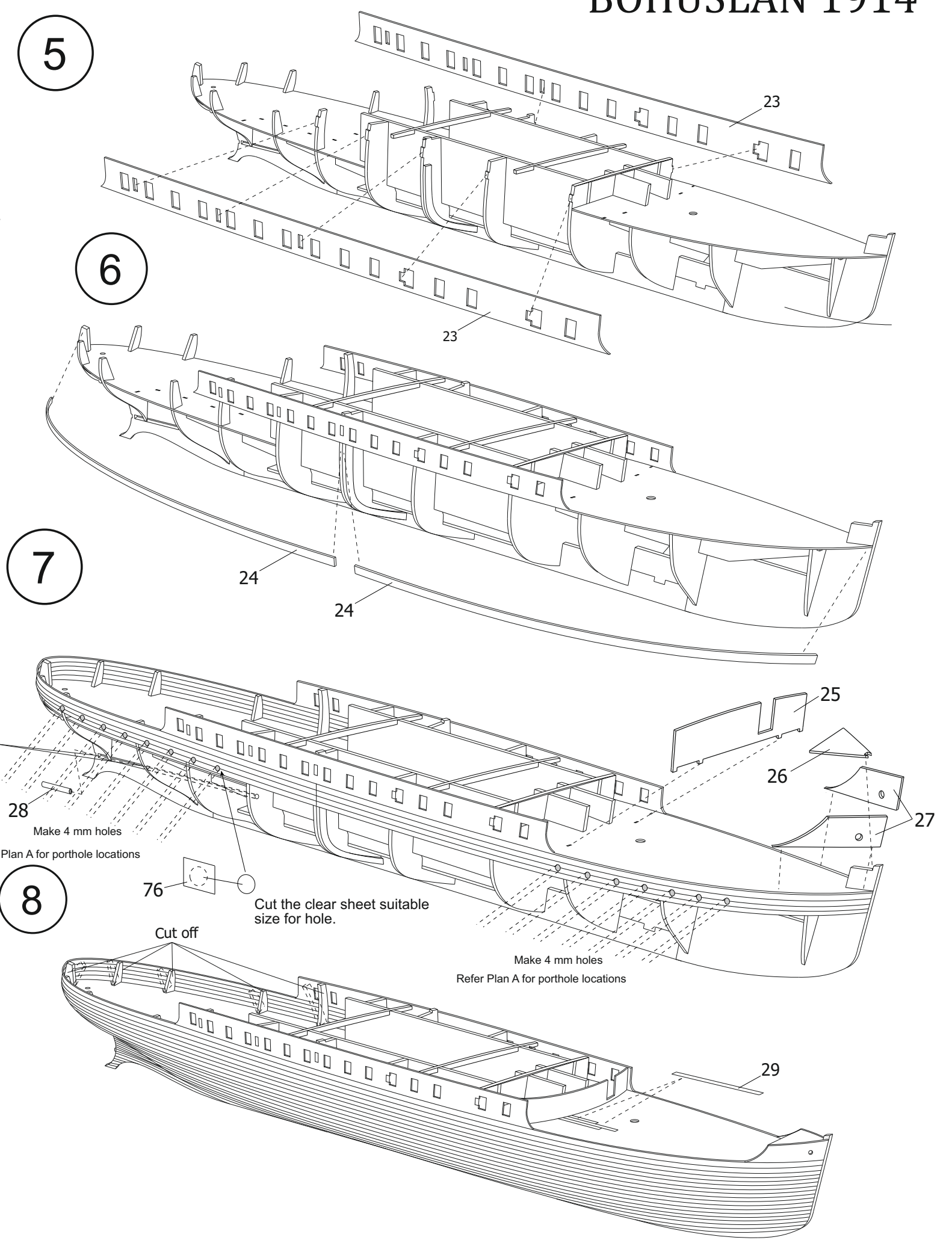
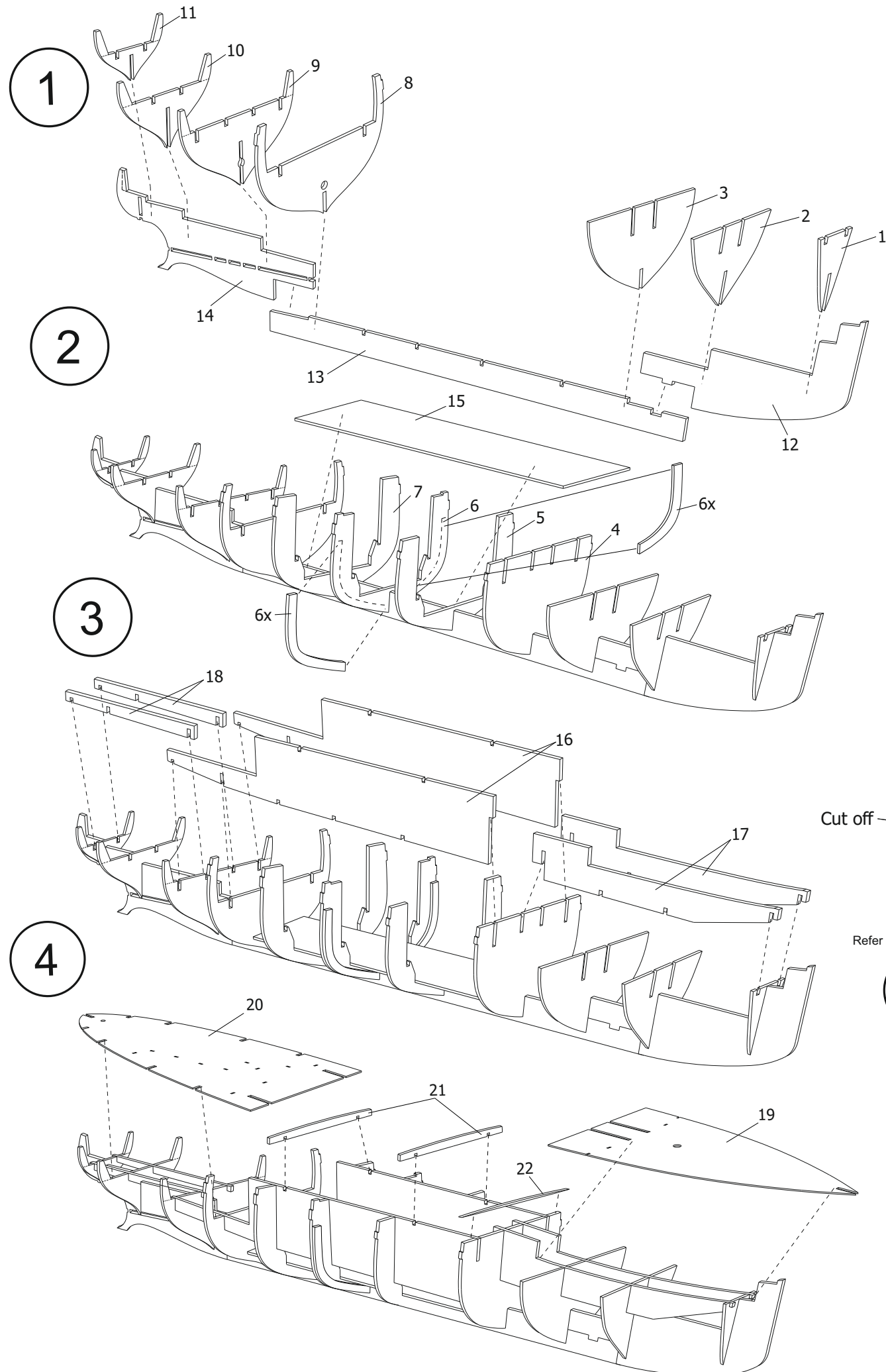

9

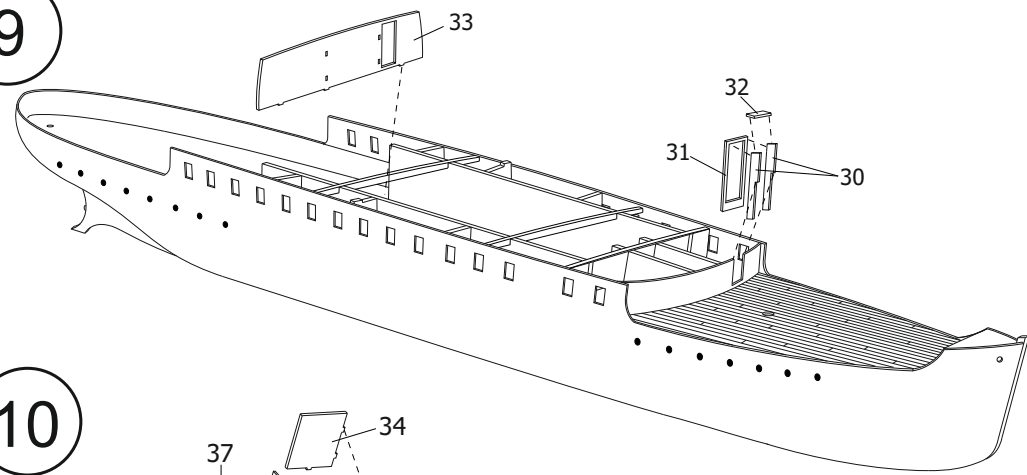

16

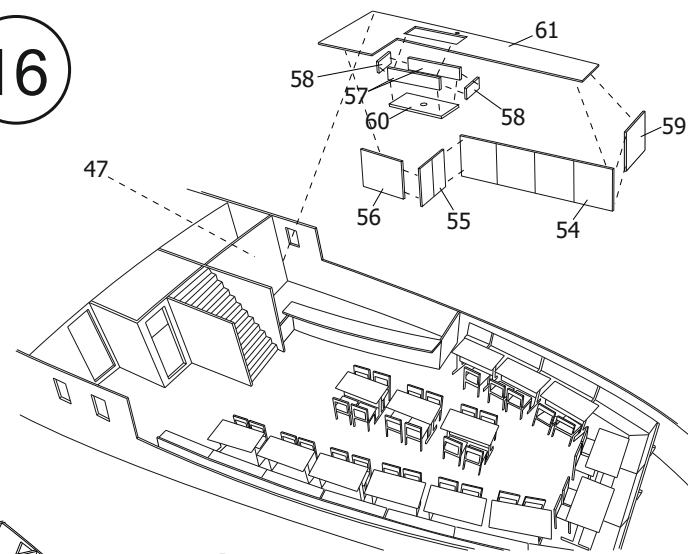

17

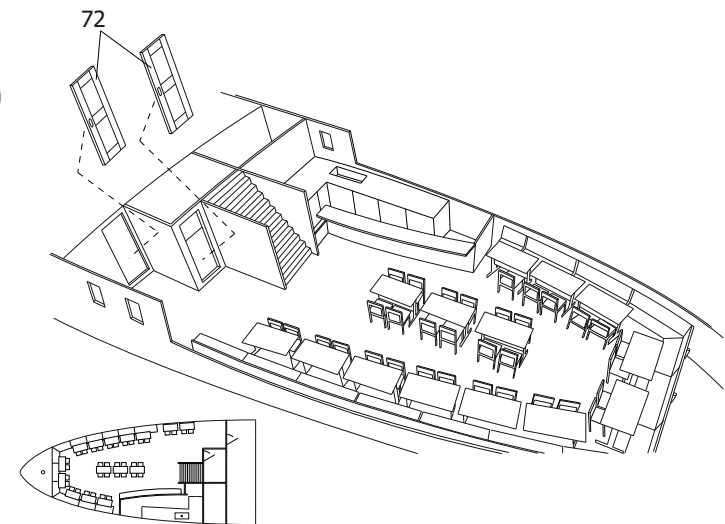

10

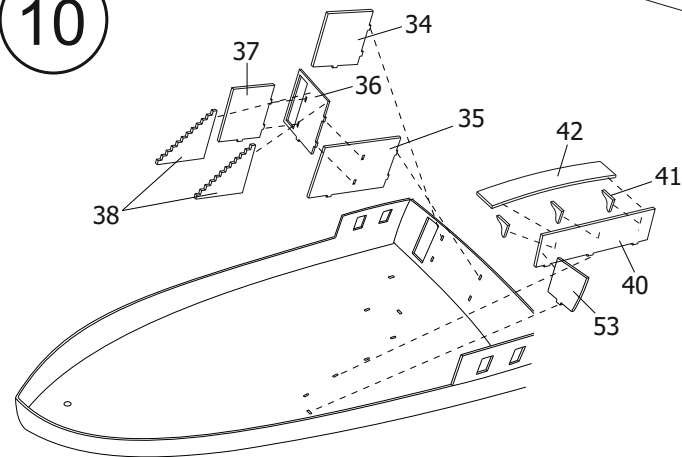

13

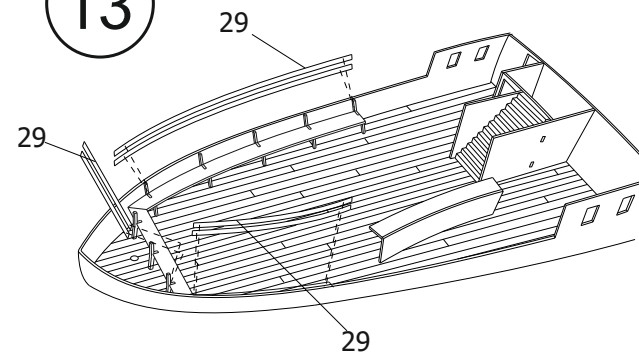

19

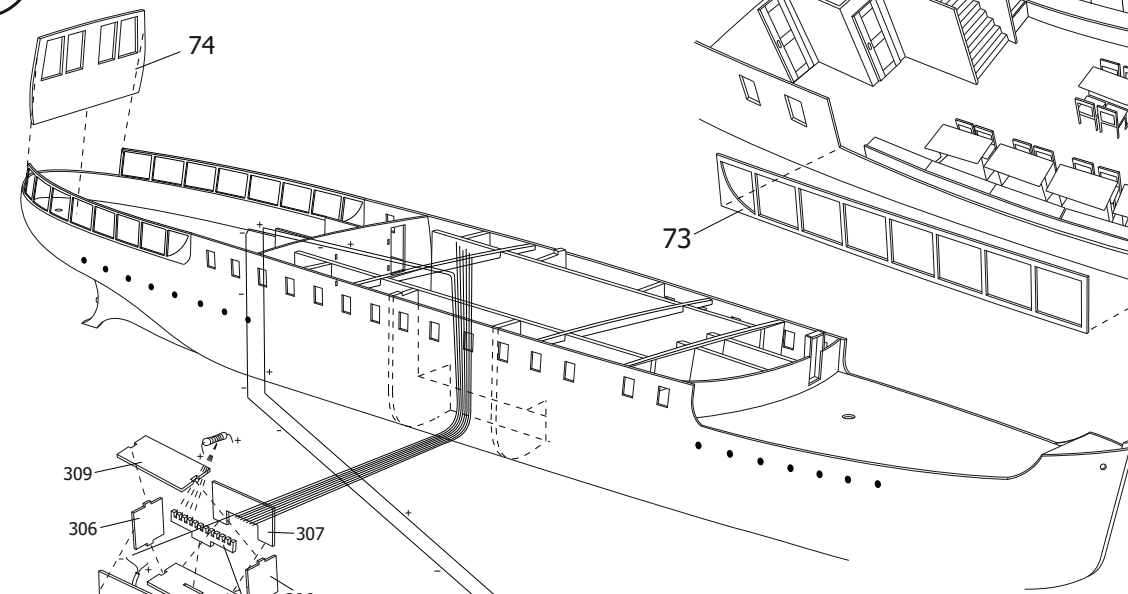

18

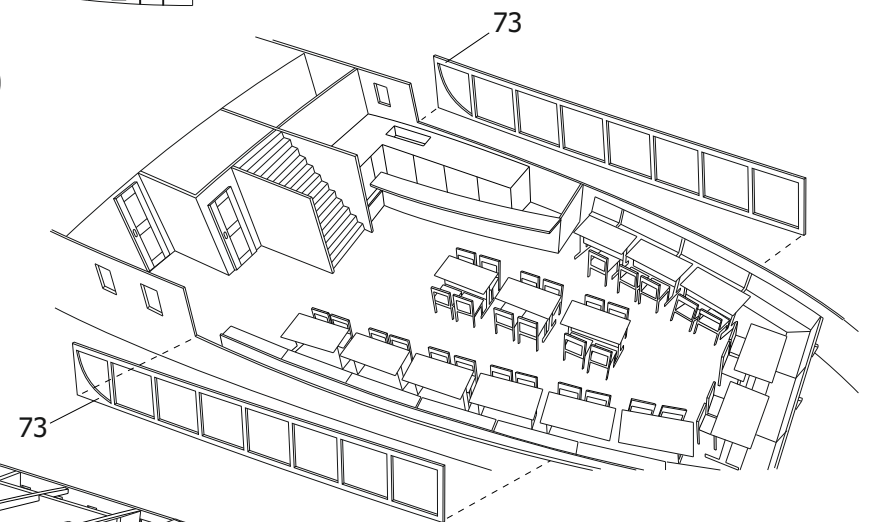

11

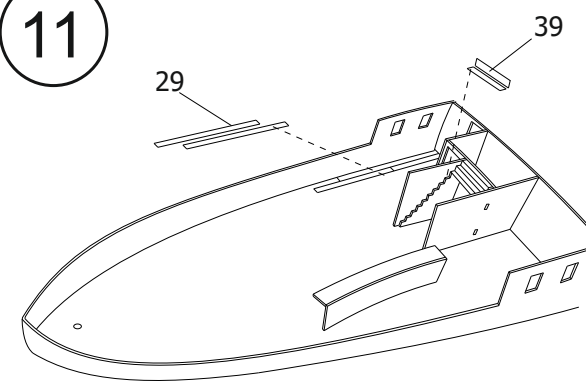

14

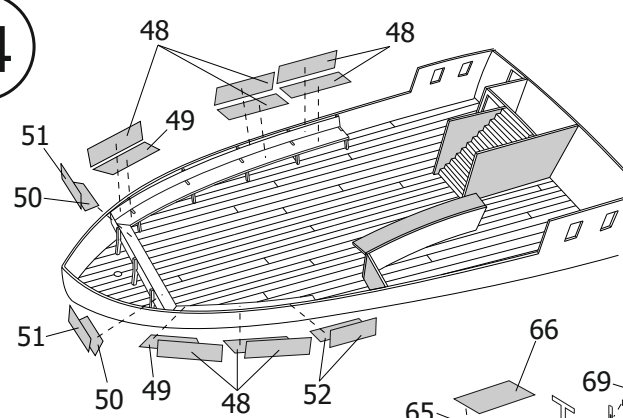

12

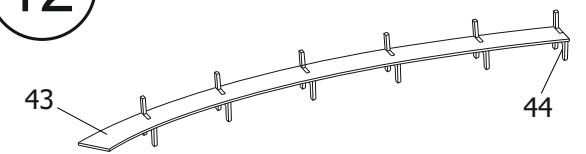

15

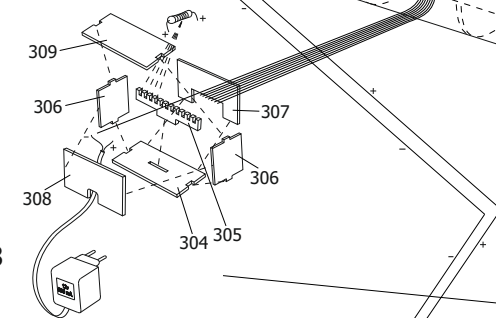
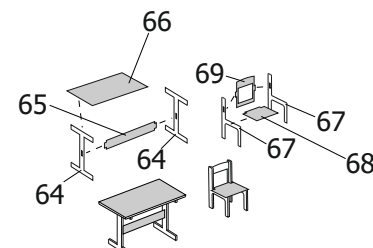
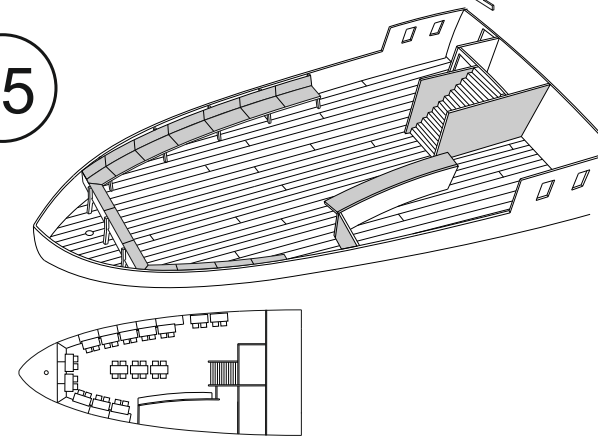

It is adaptor is not included in the kit.
Needed when only lighting kit is bought.

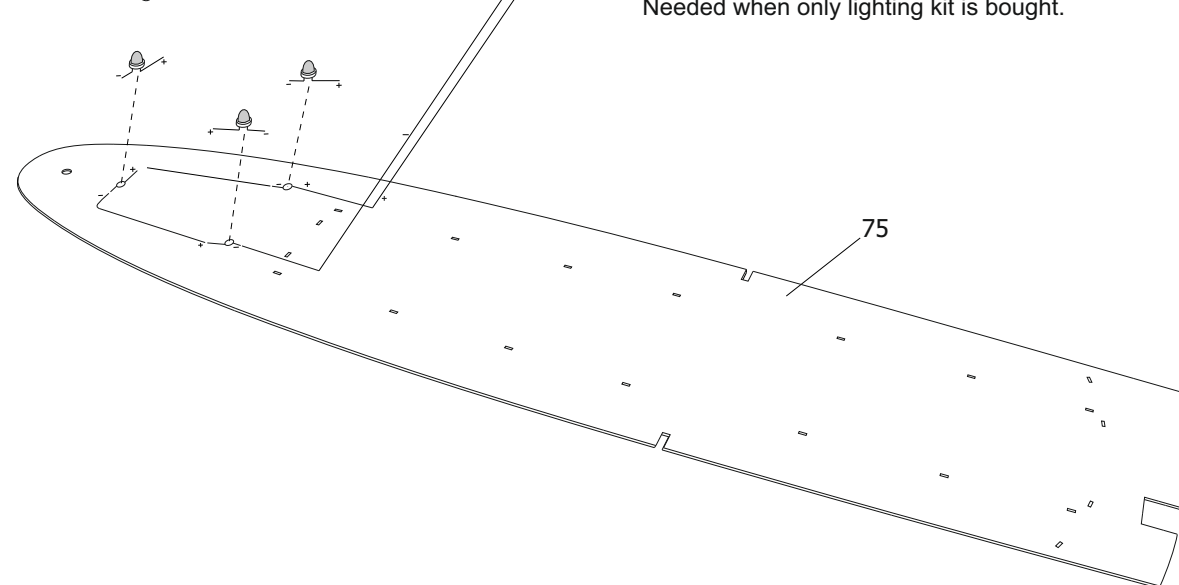

20

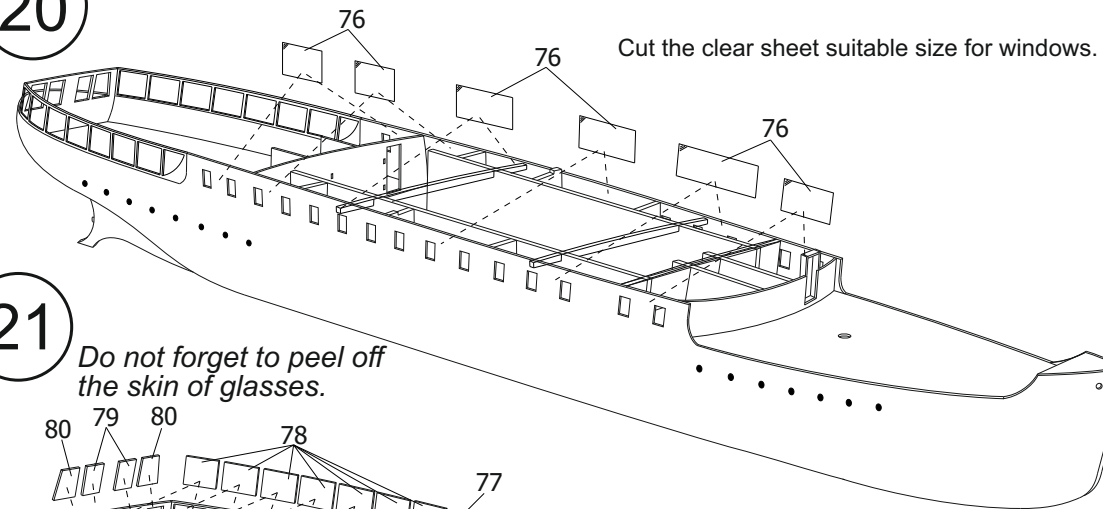

21

Do not forget to peel off the skin of glasses.

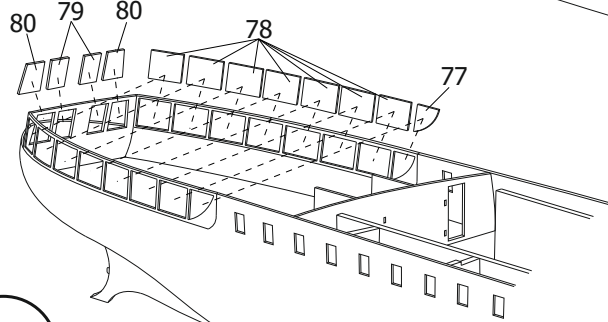

22

Warning! You should see R/C plan sheet before starting drawing 22 If you will convert the model to R/C.

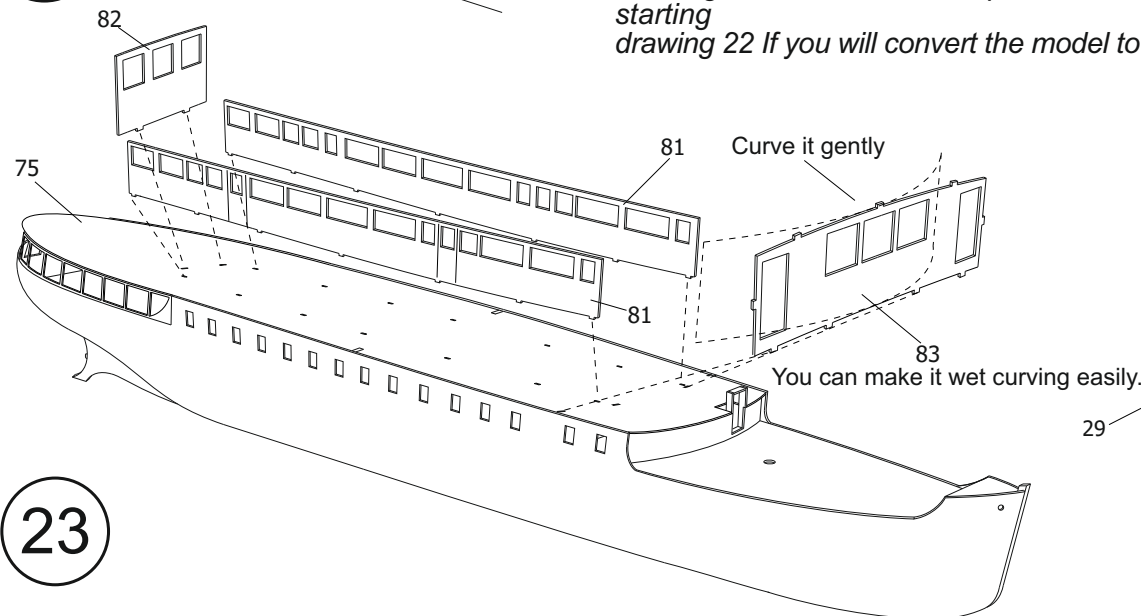

23

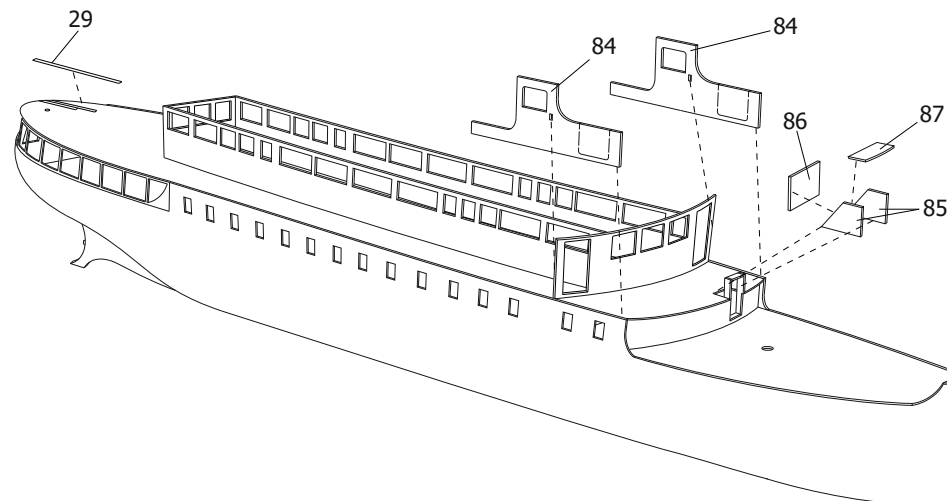

24

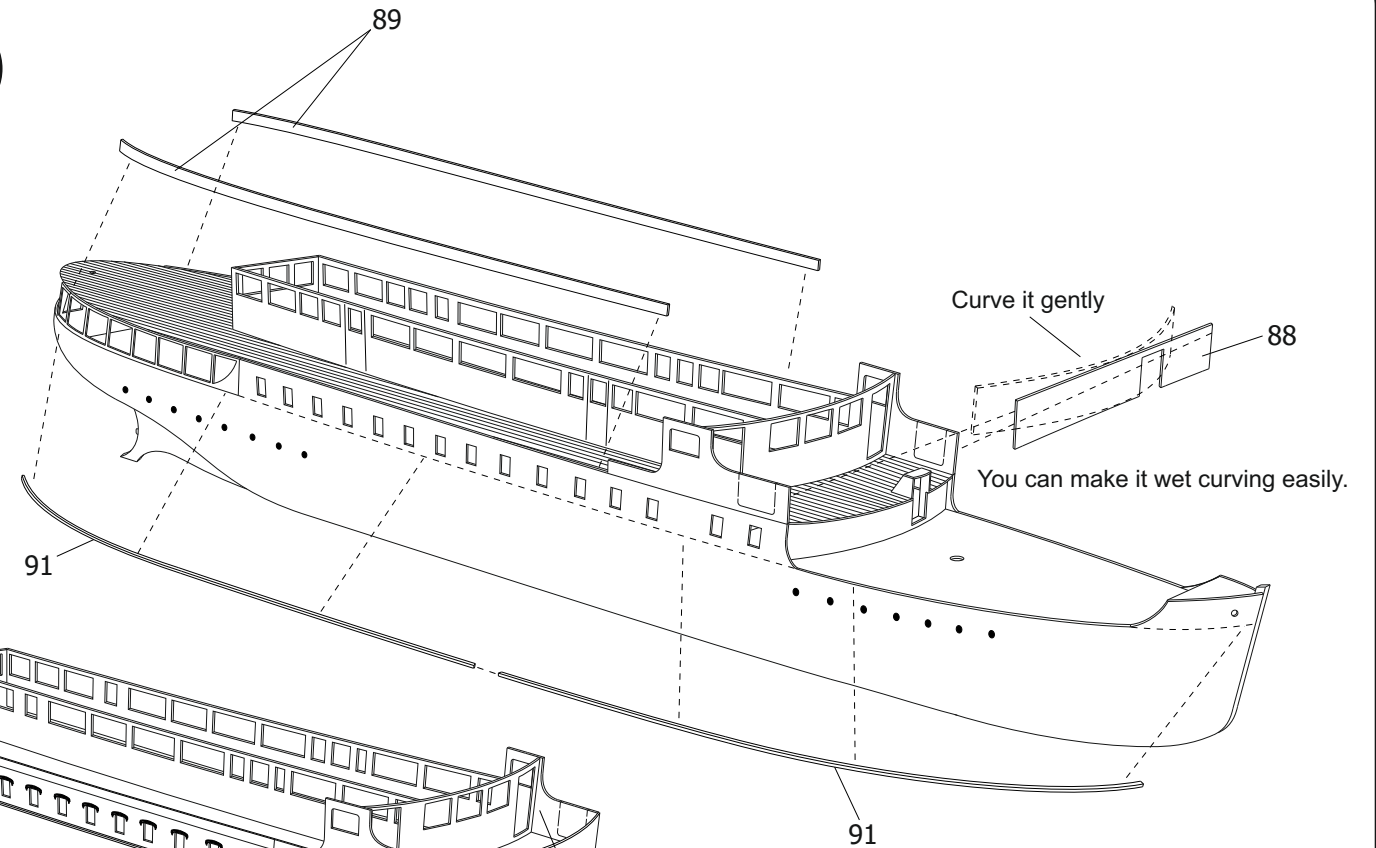

25

Curve it gently

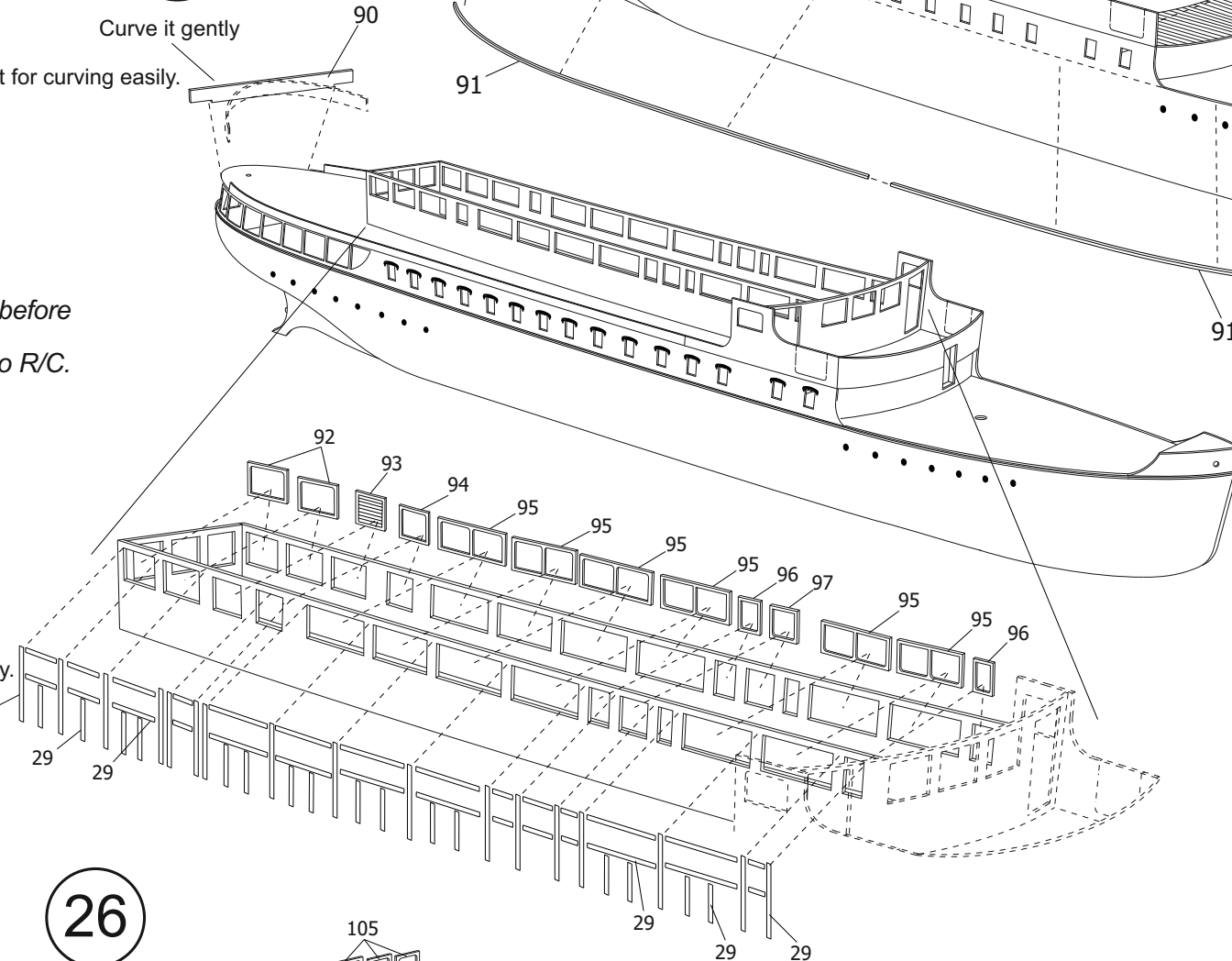

26

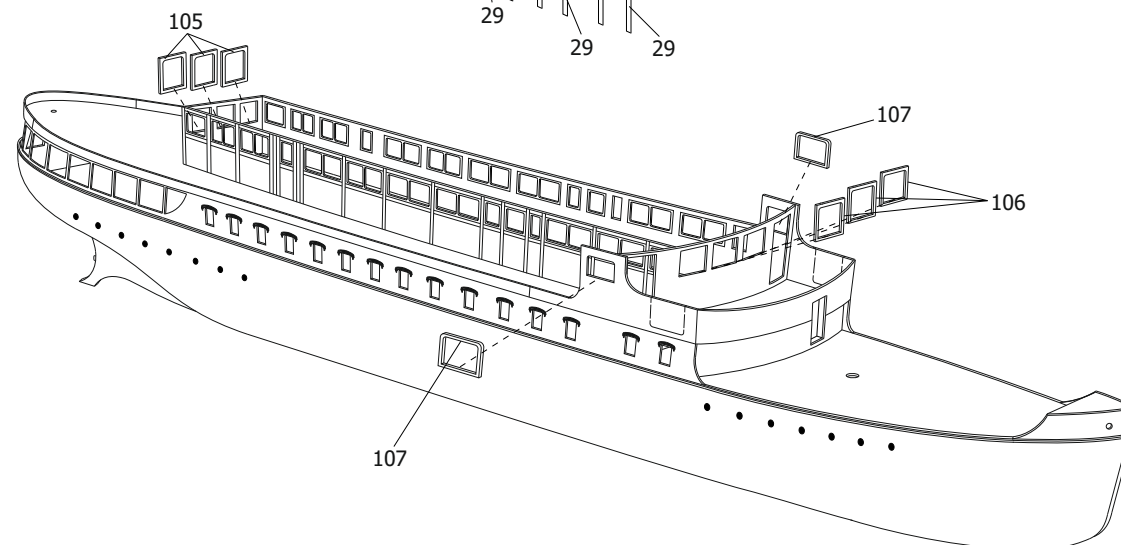

27

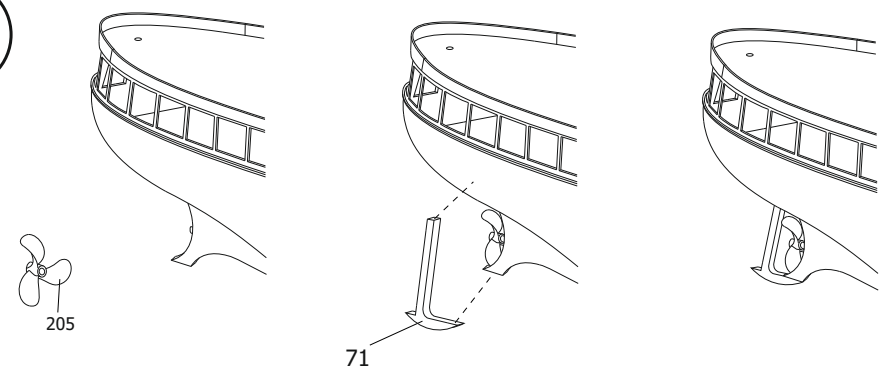

28

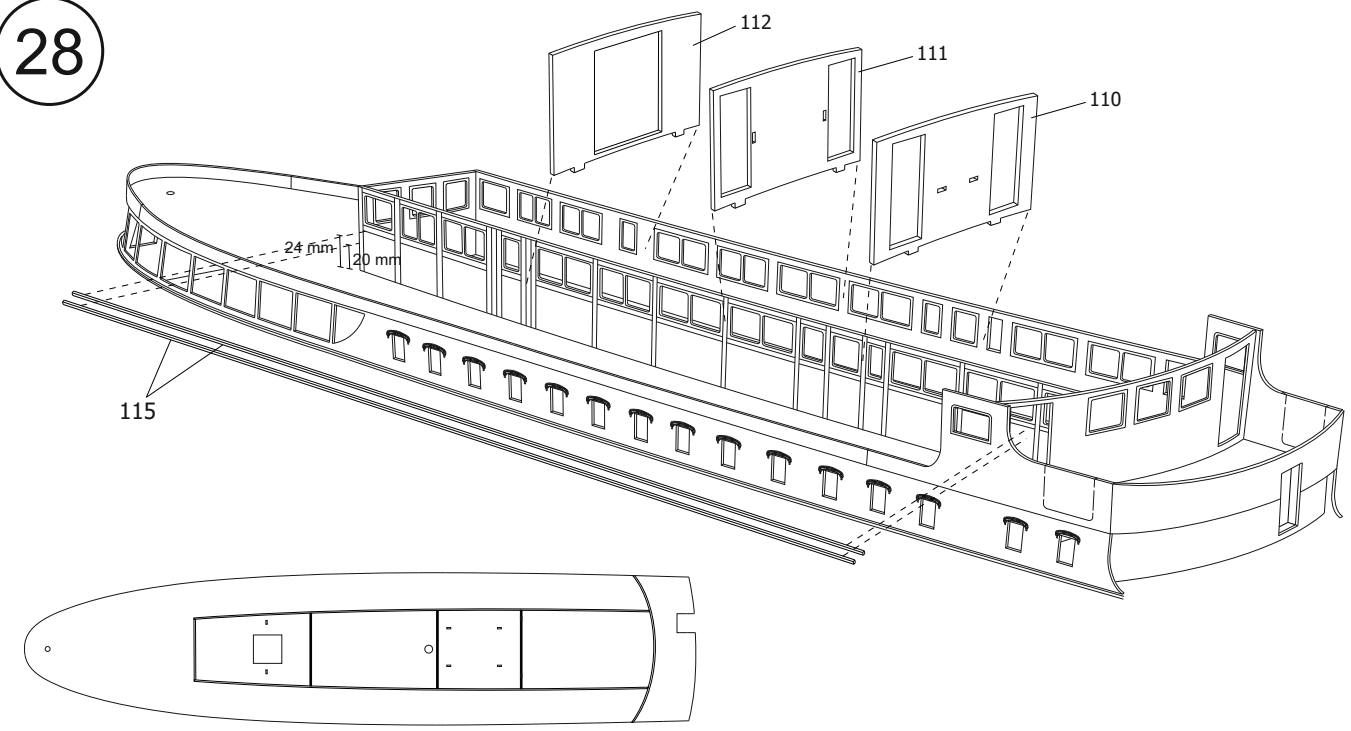

29

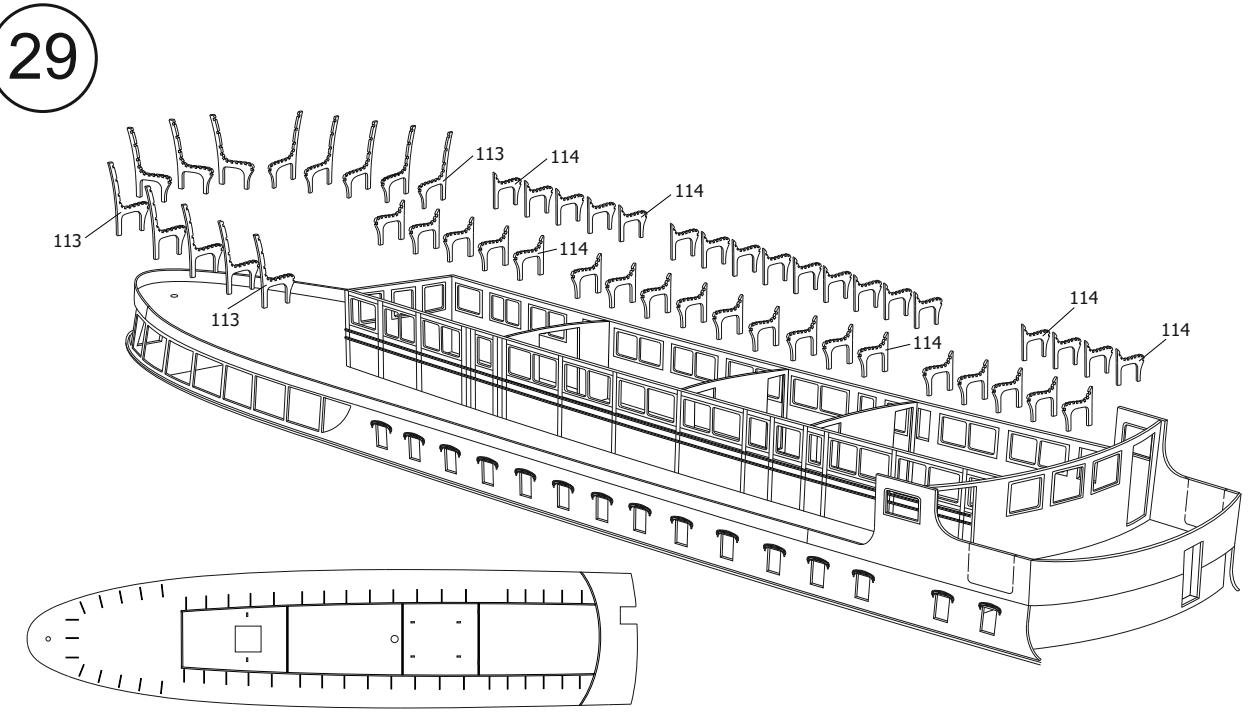

30

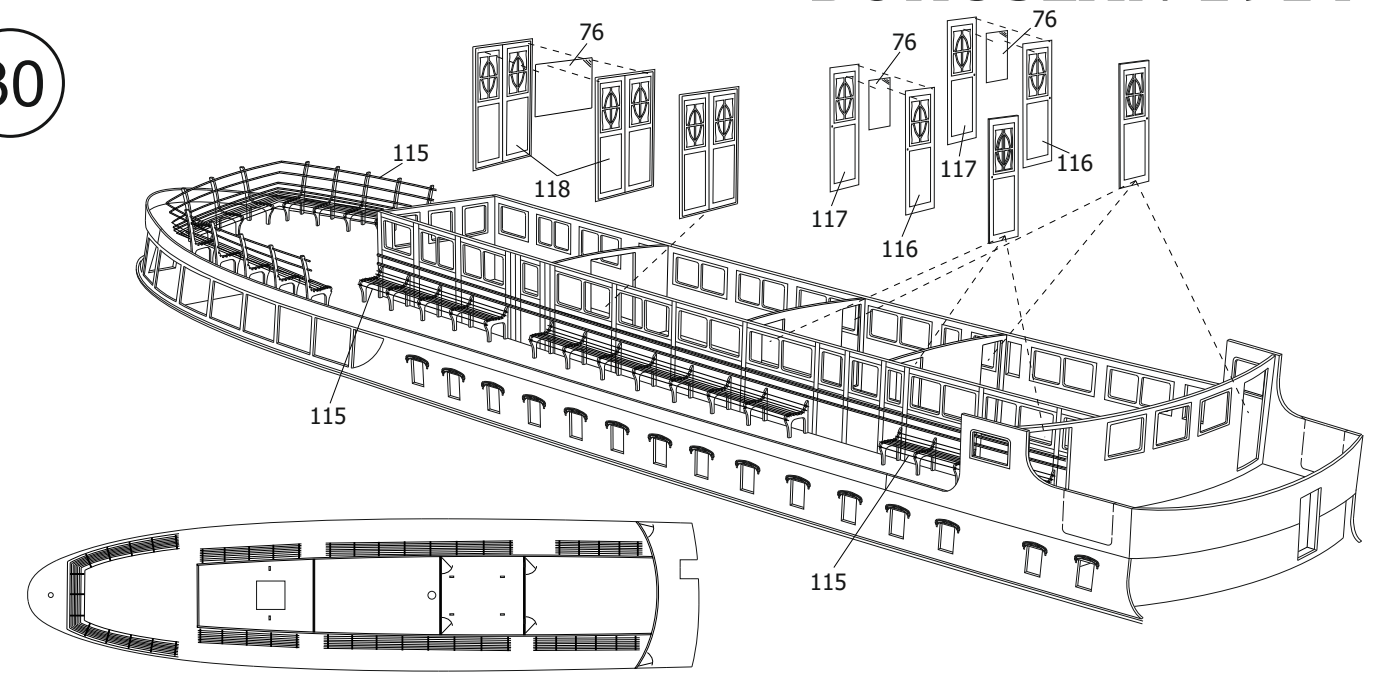

31

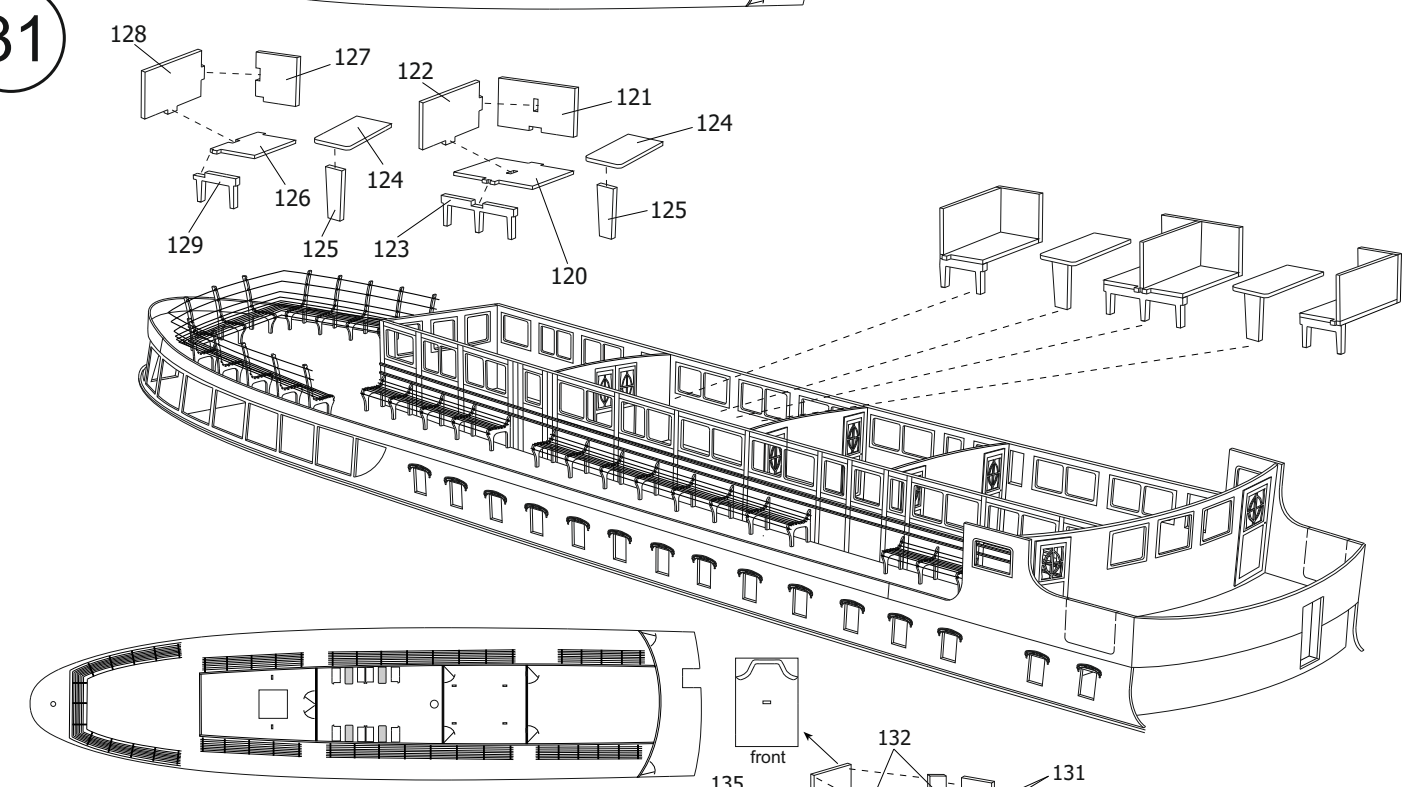

32

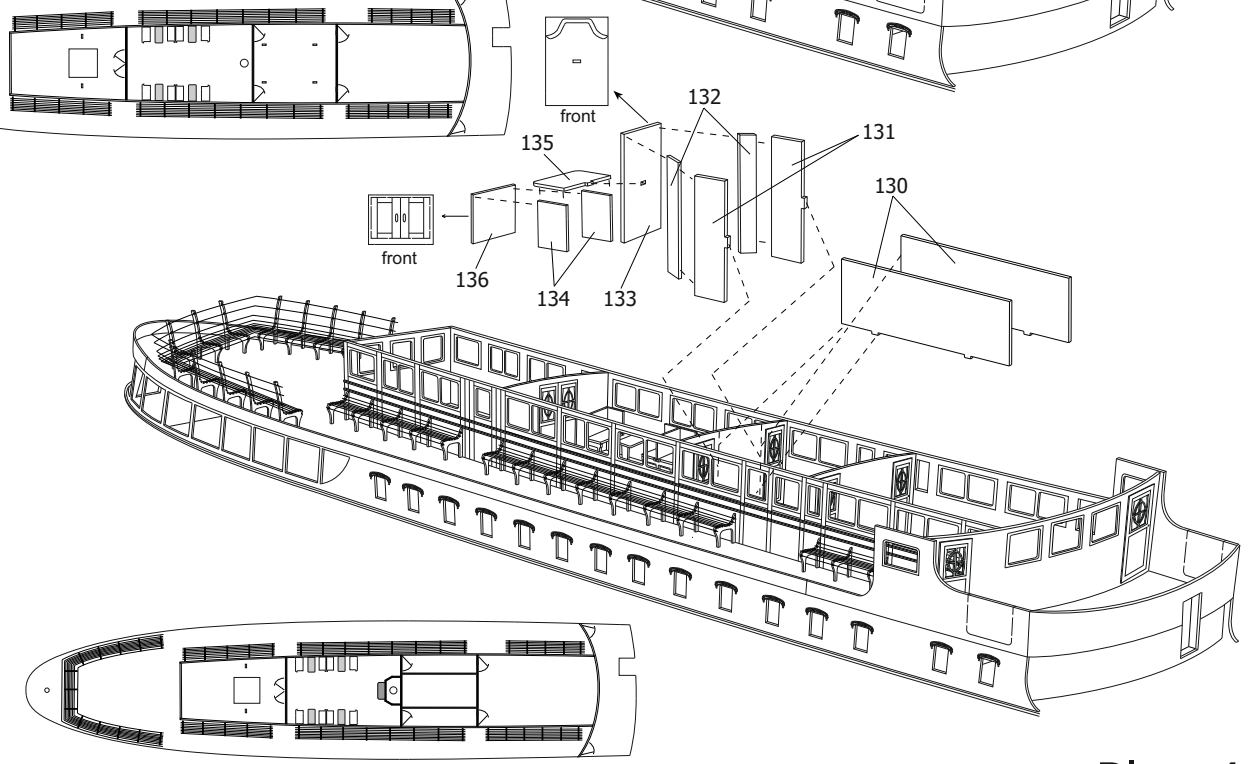

33

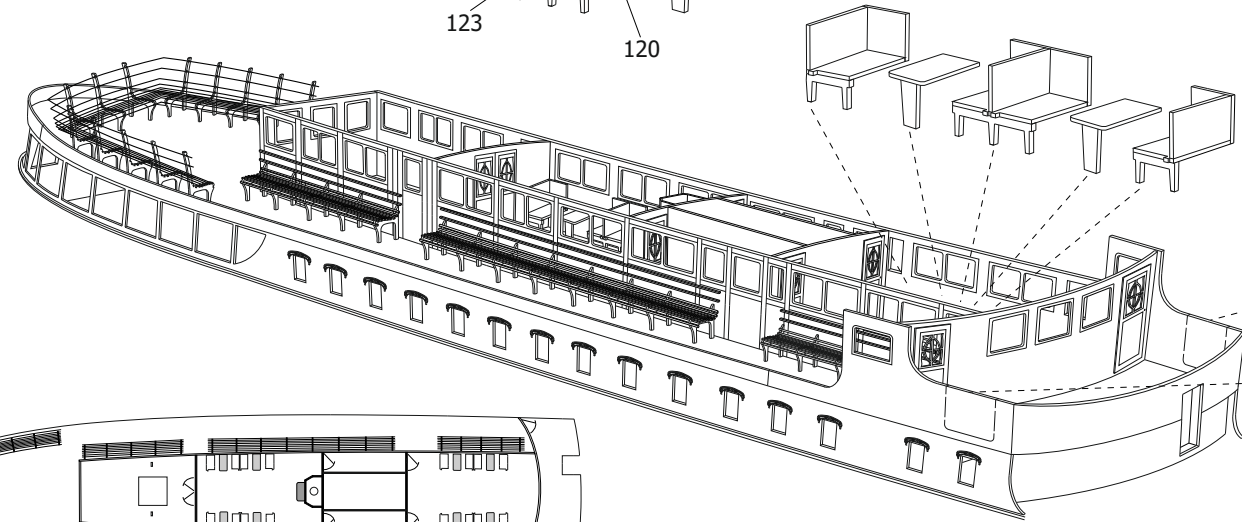
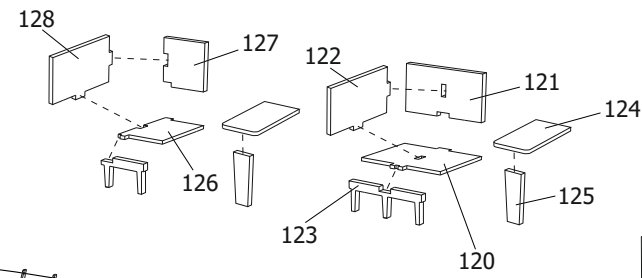

35

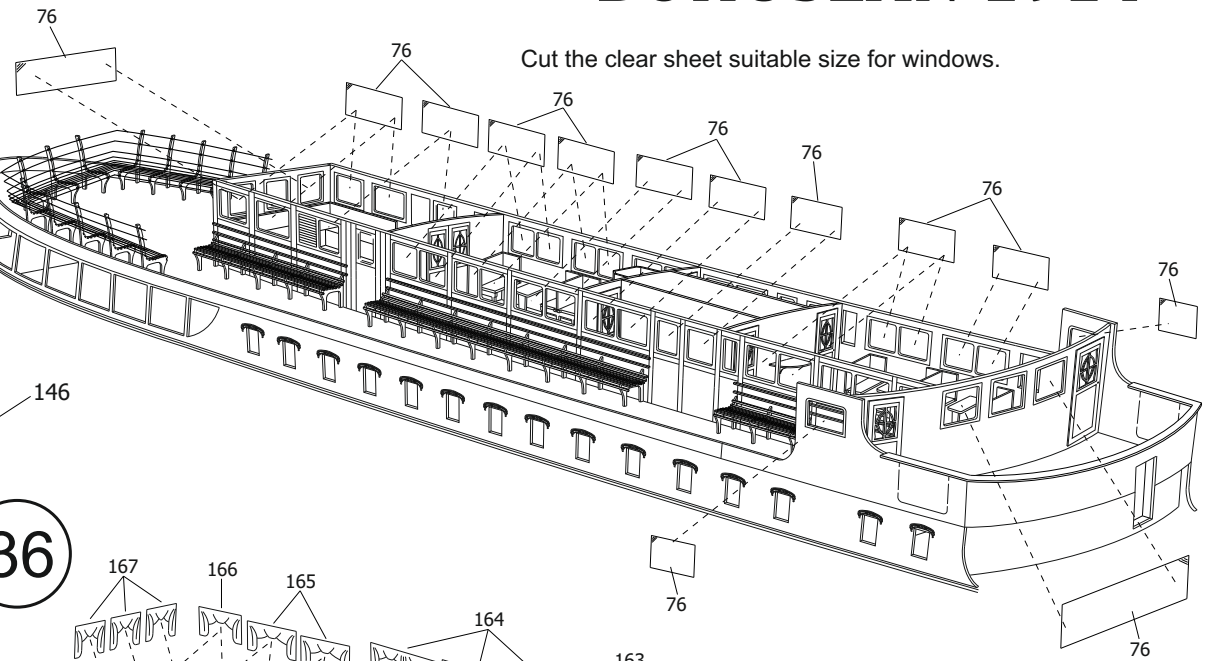

36

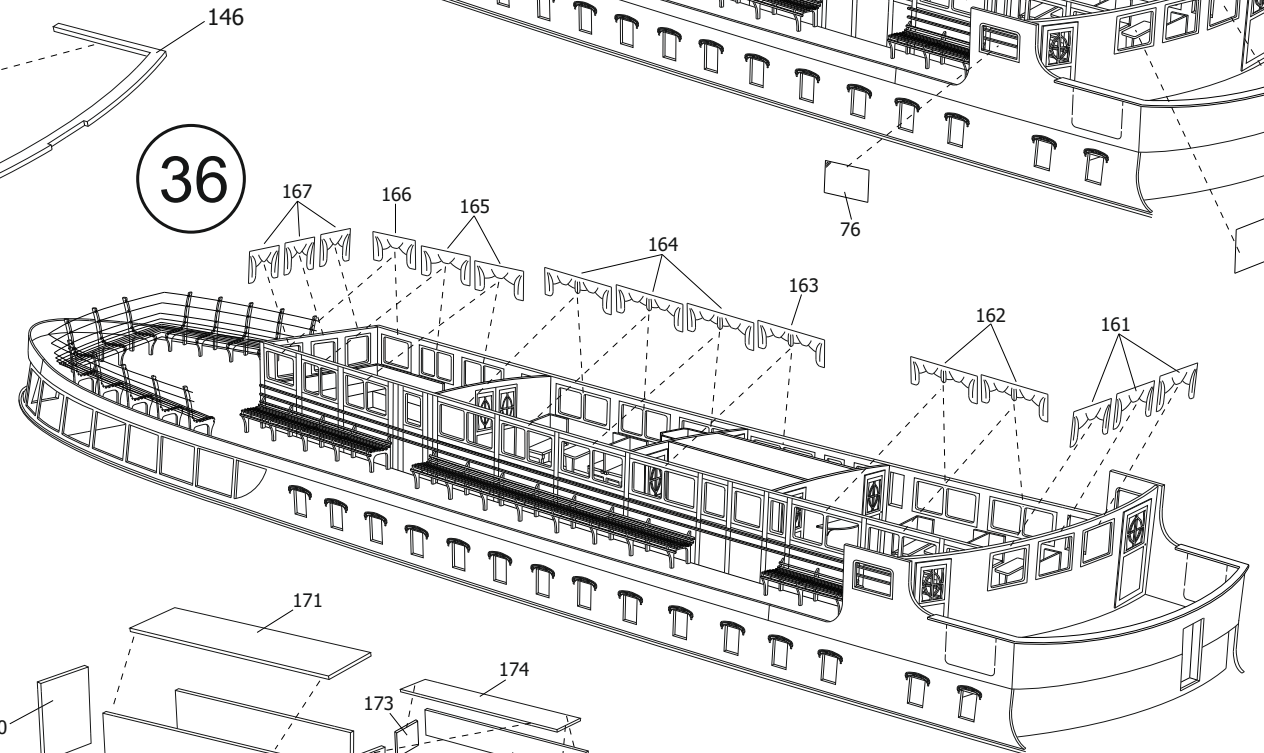

37

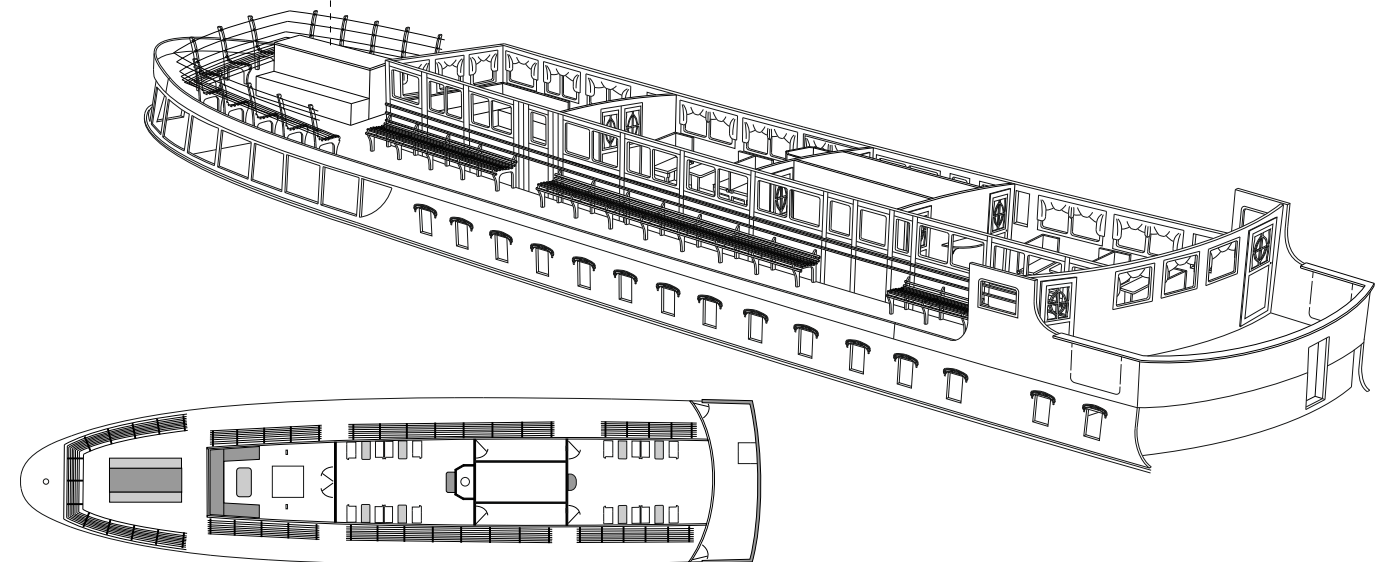
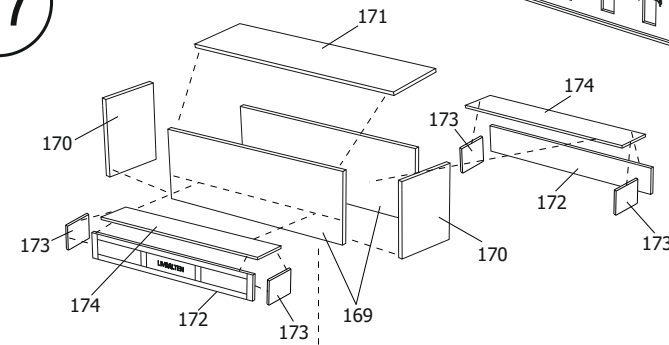

34

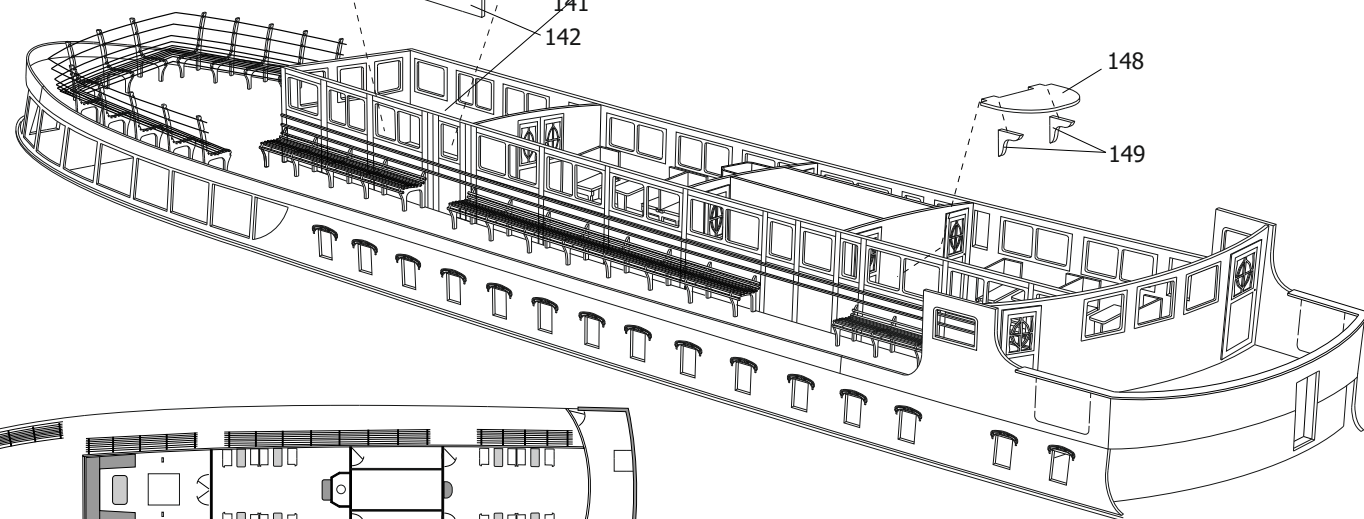
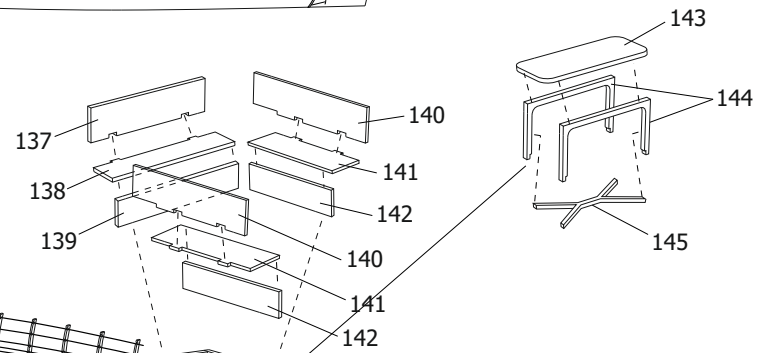

38

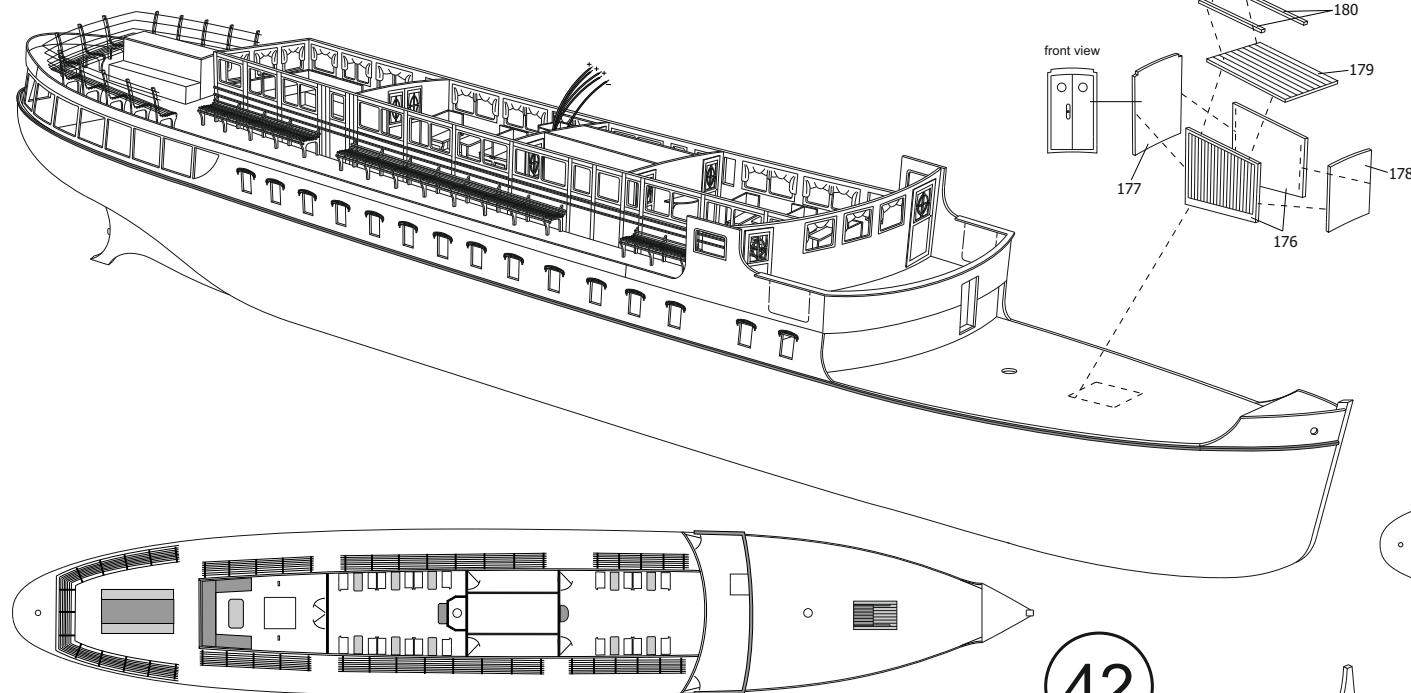

41

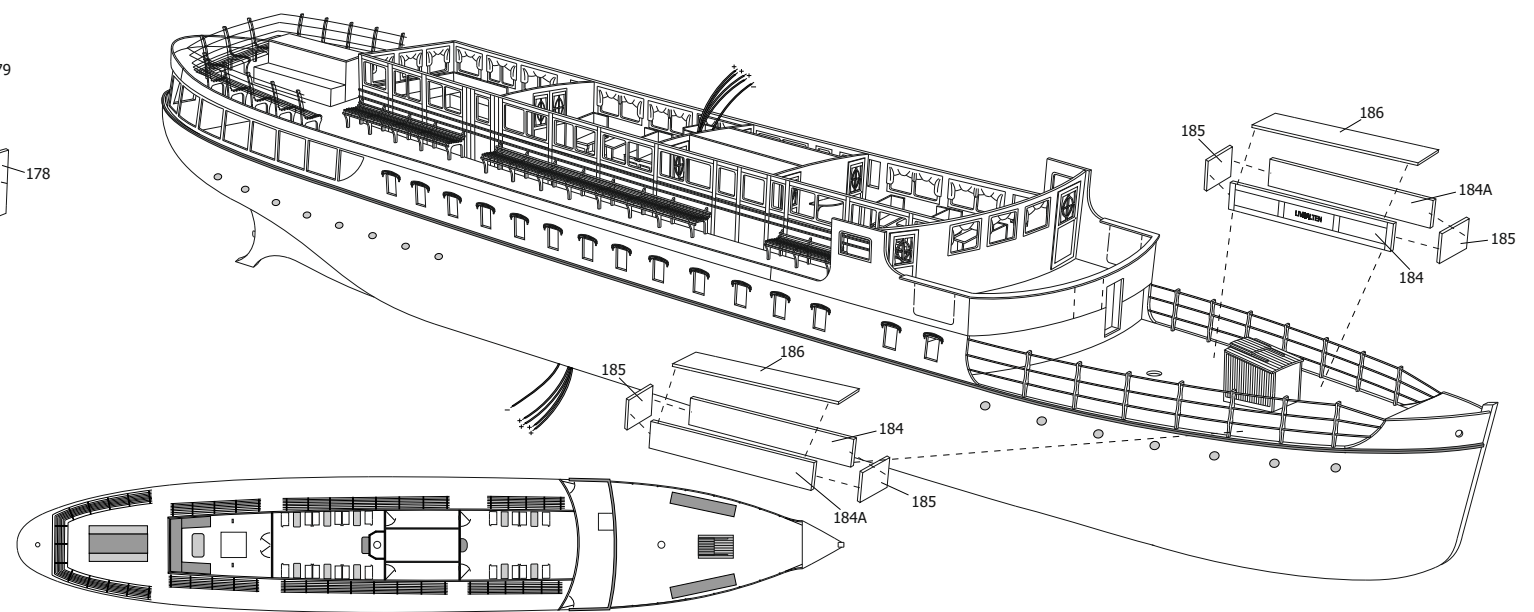

42

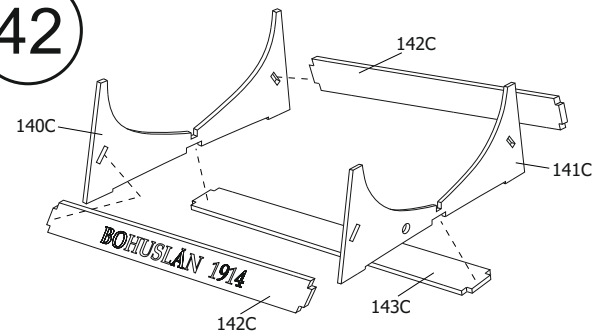

39

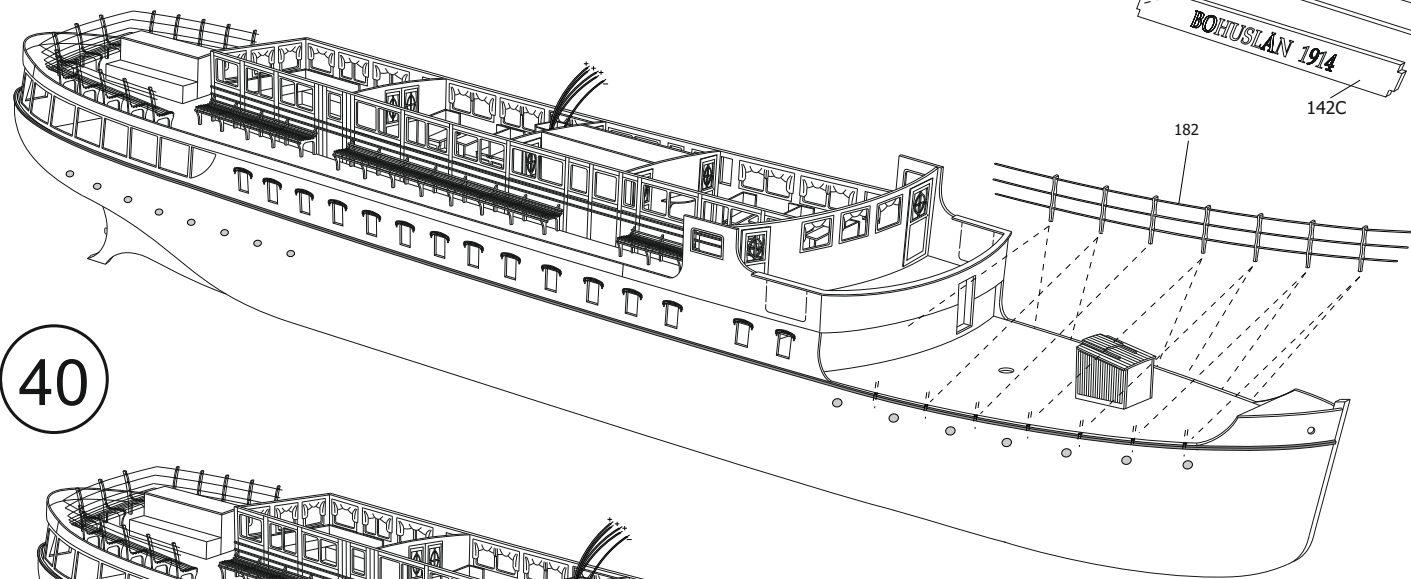

40

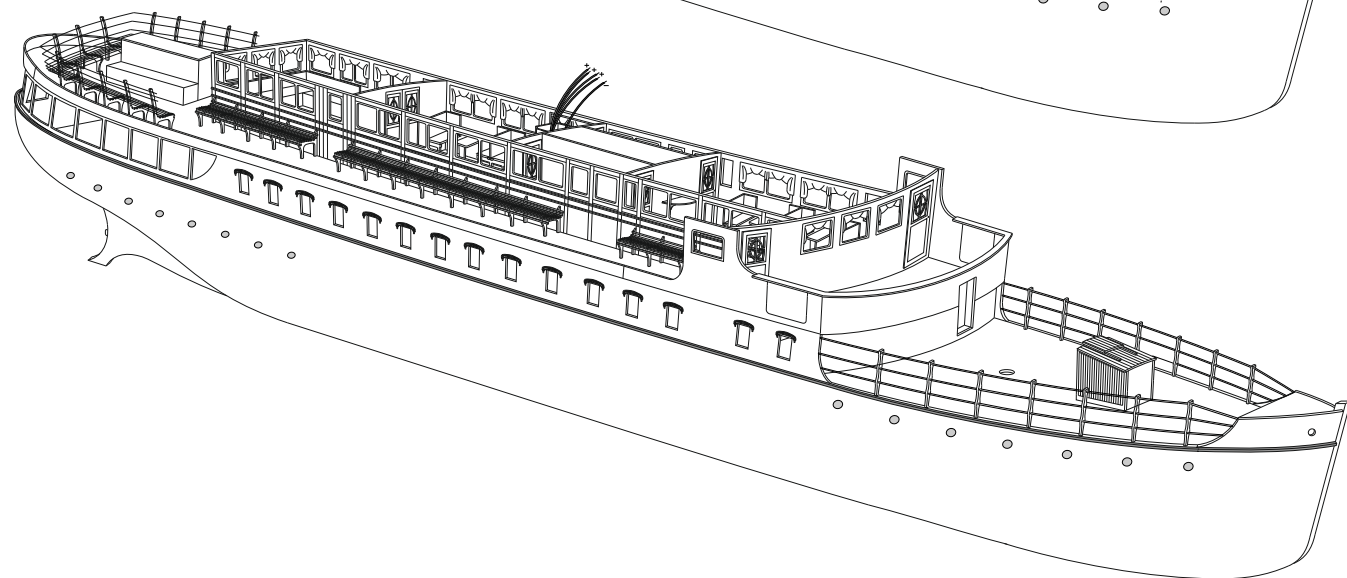

43

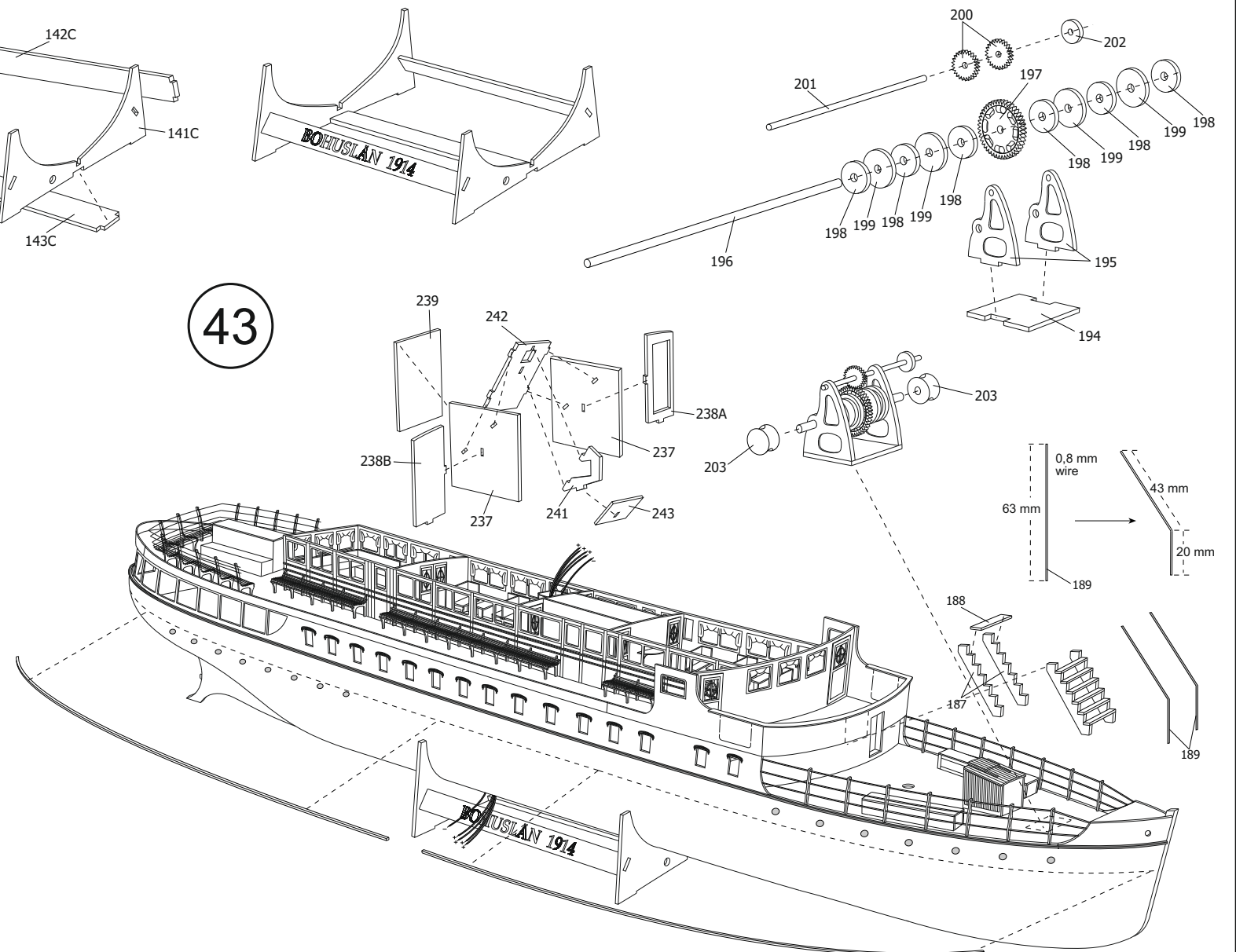

44

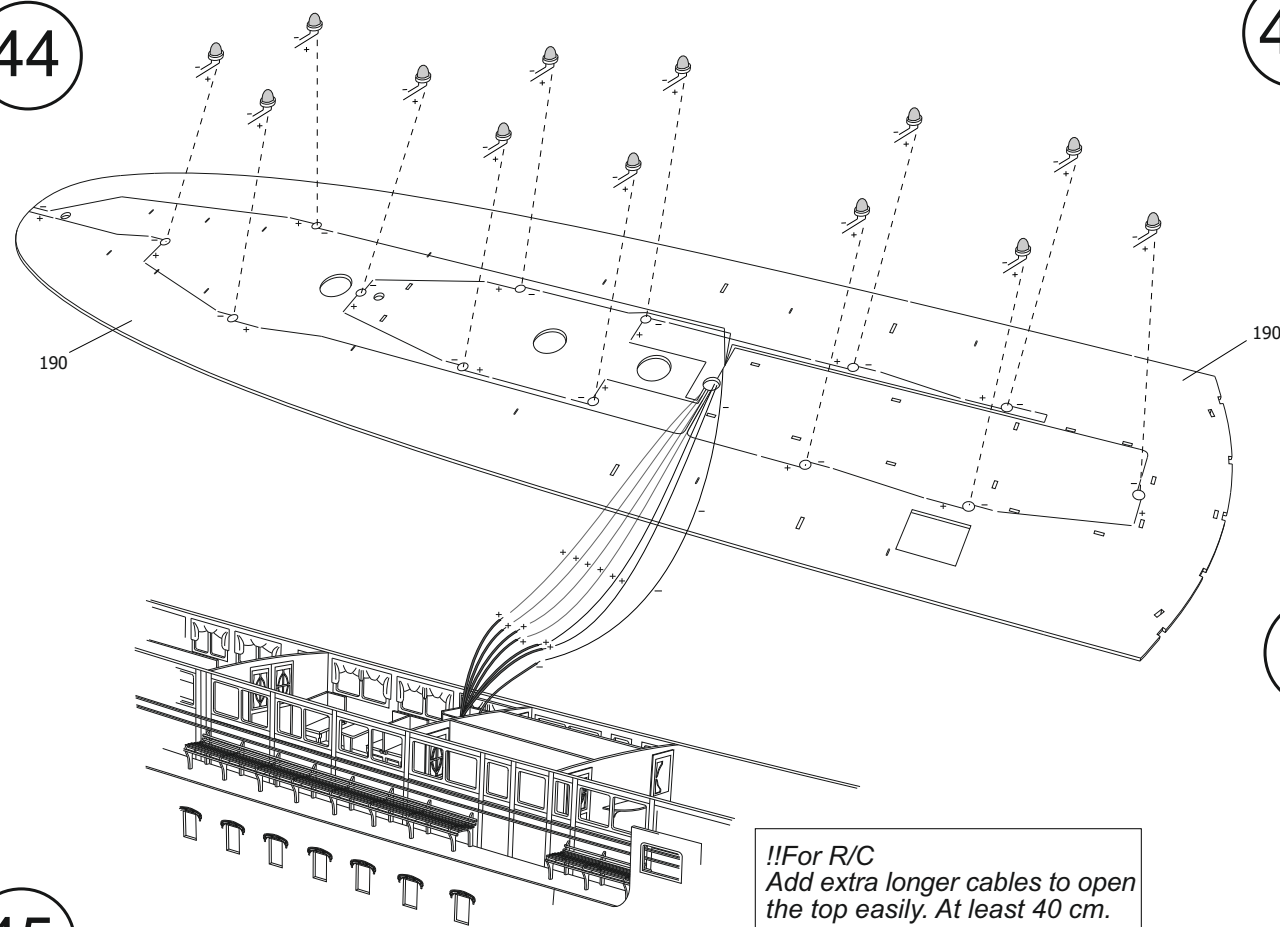

46

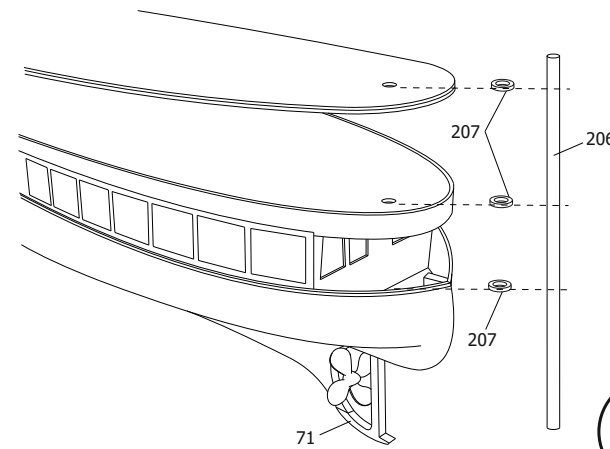

47

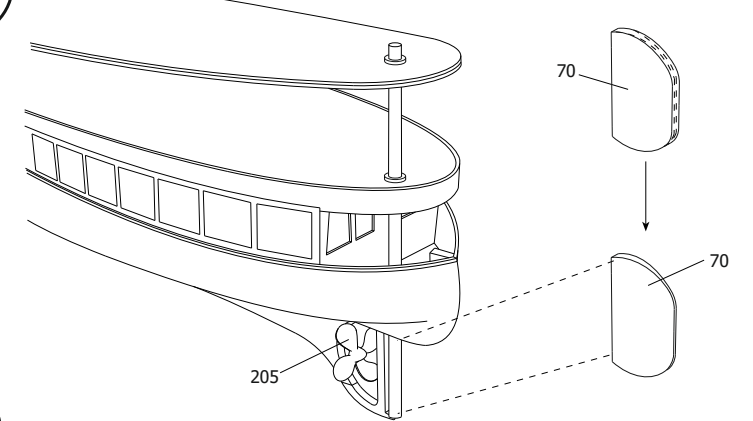

48

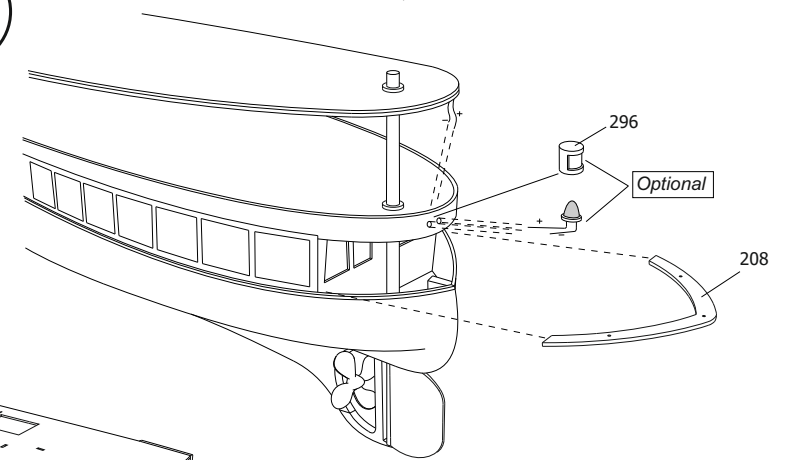

49

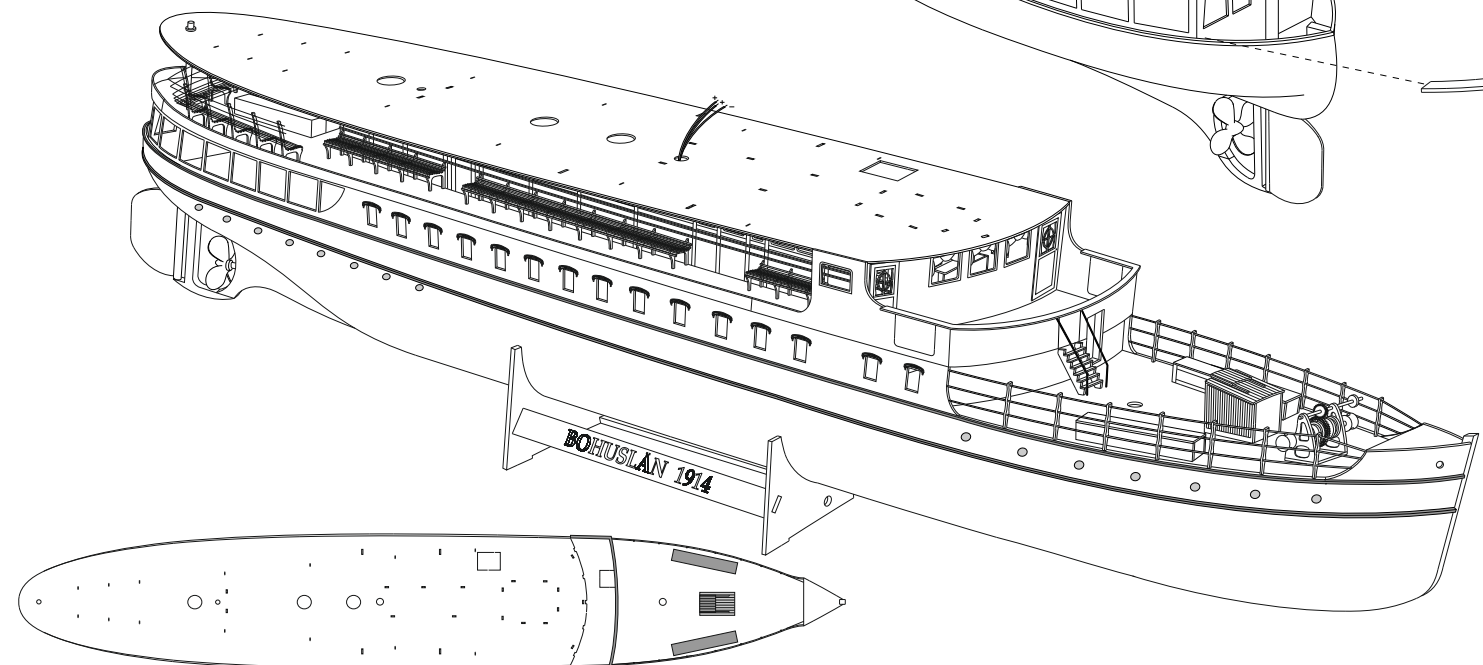

45

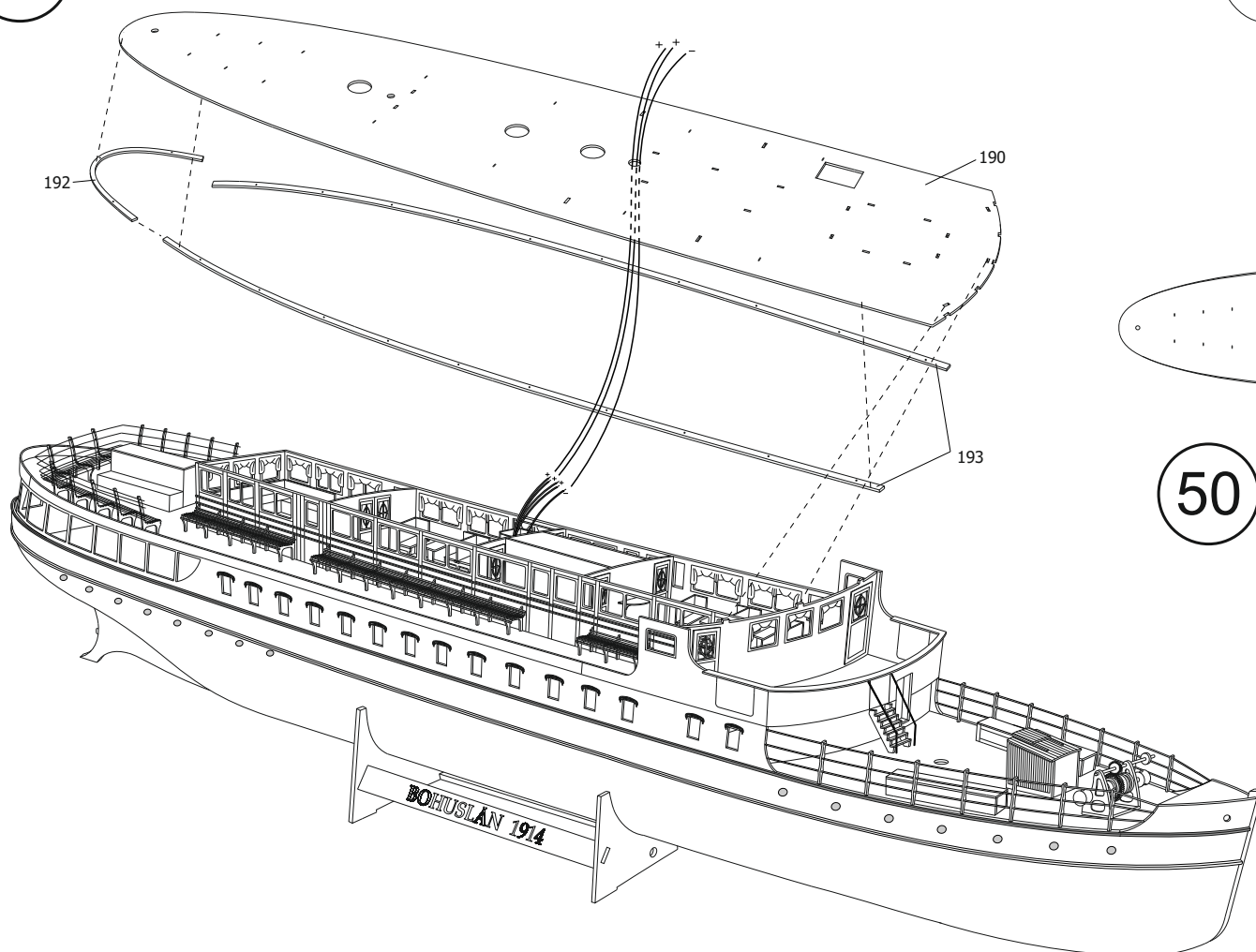

50

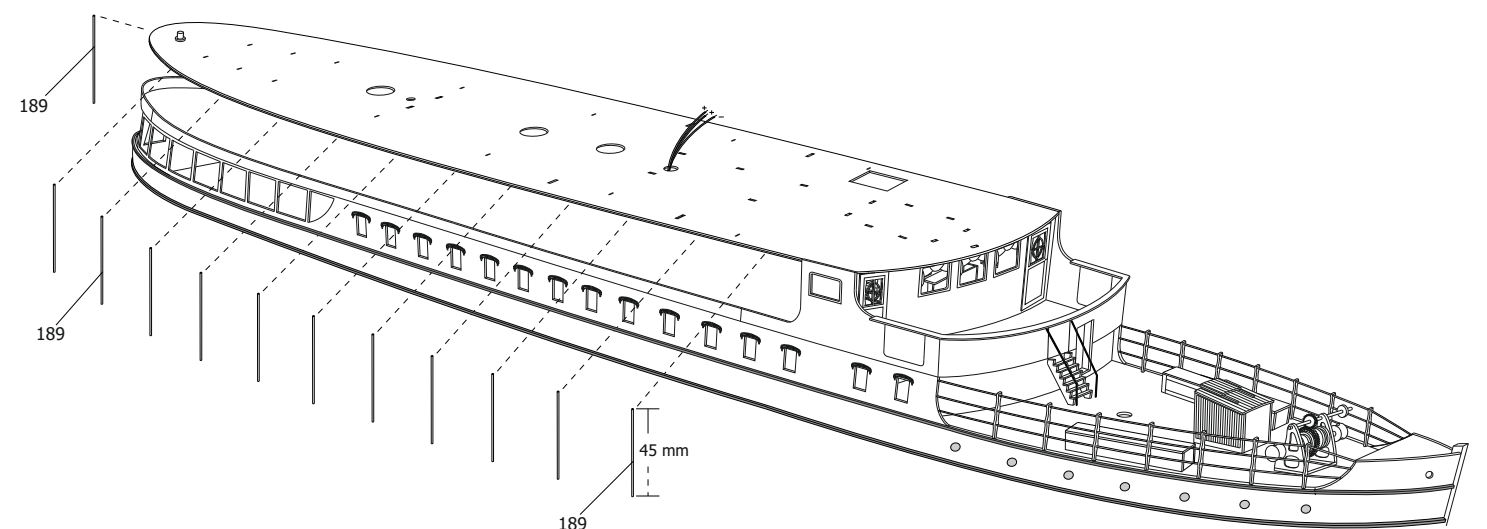

51

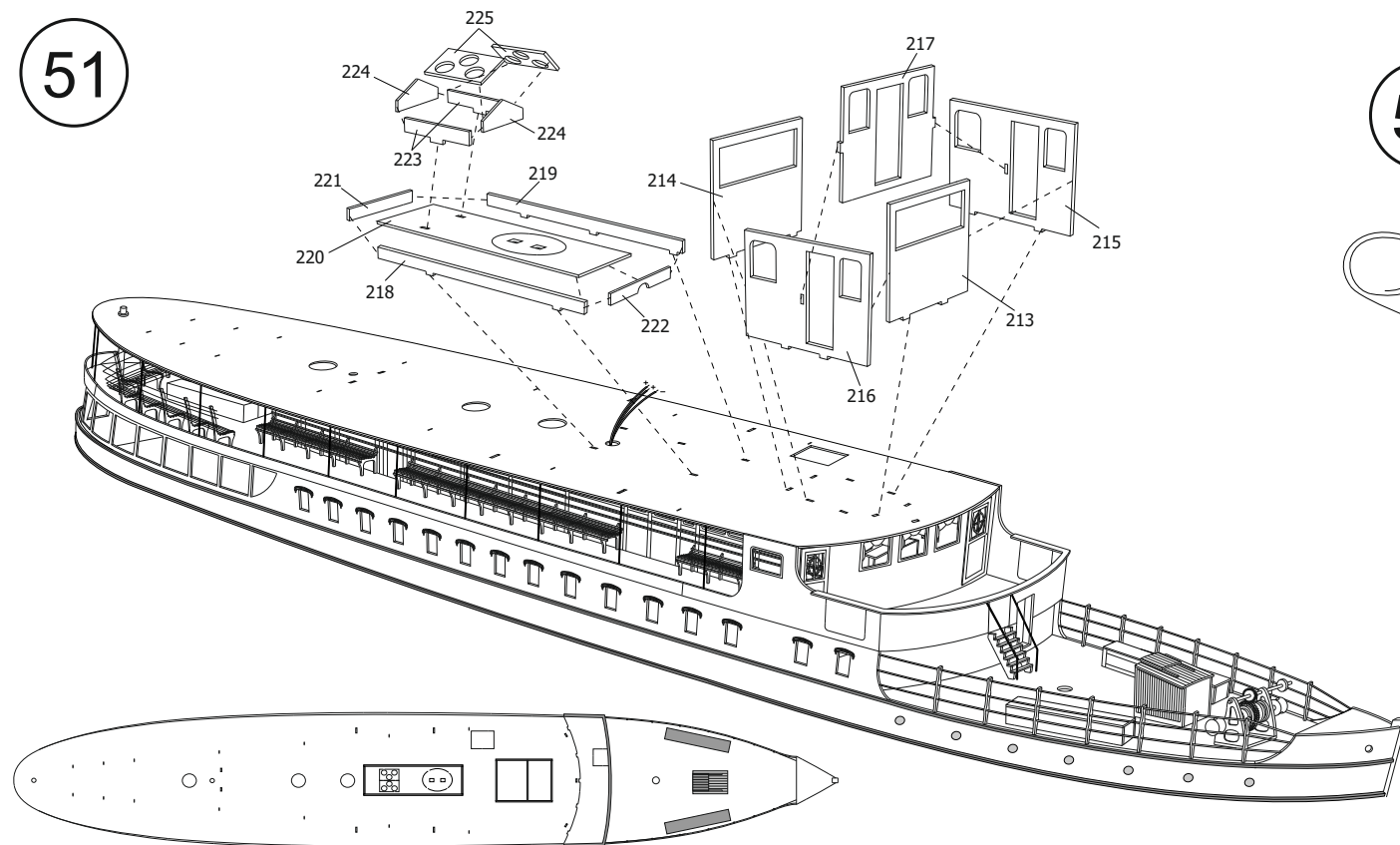

54

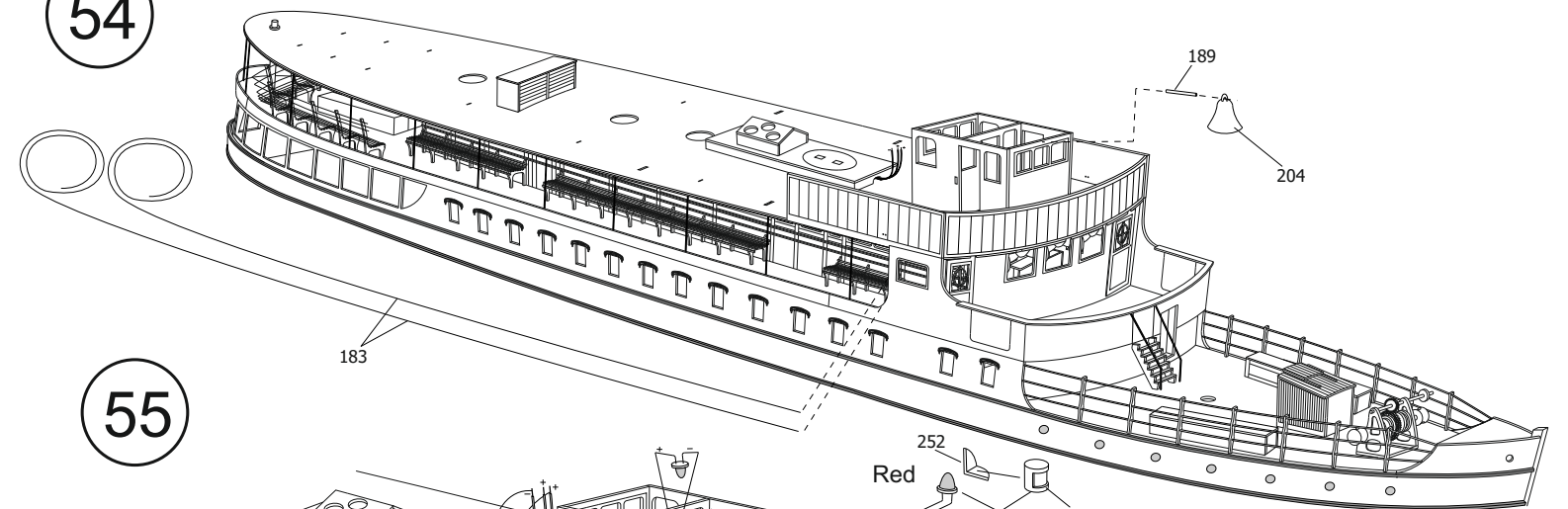

55

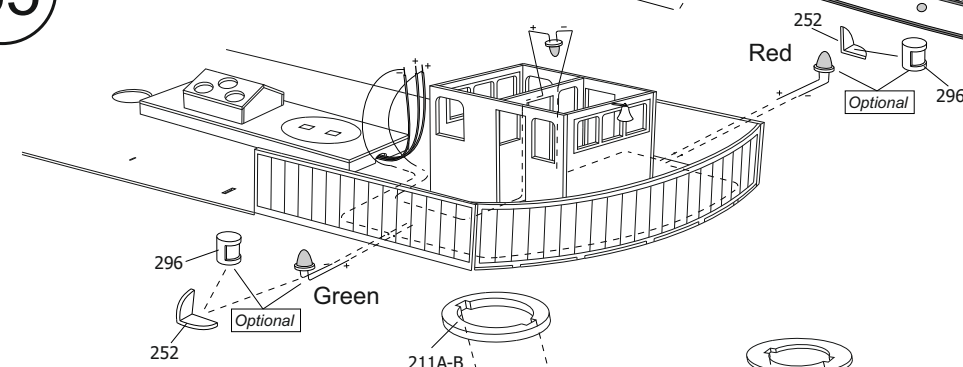

52

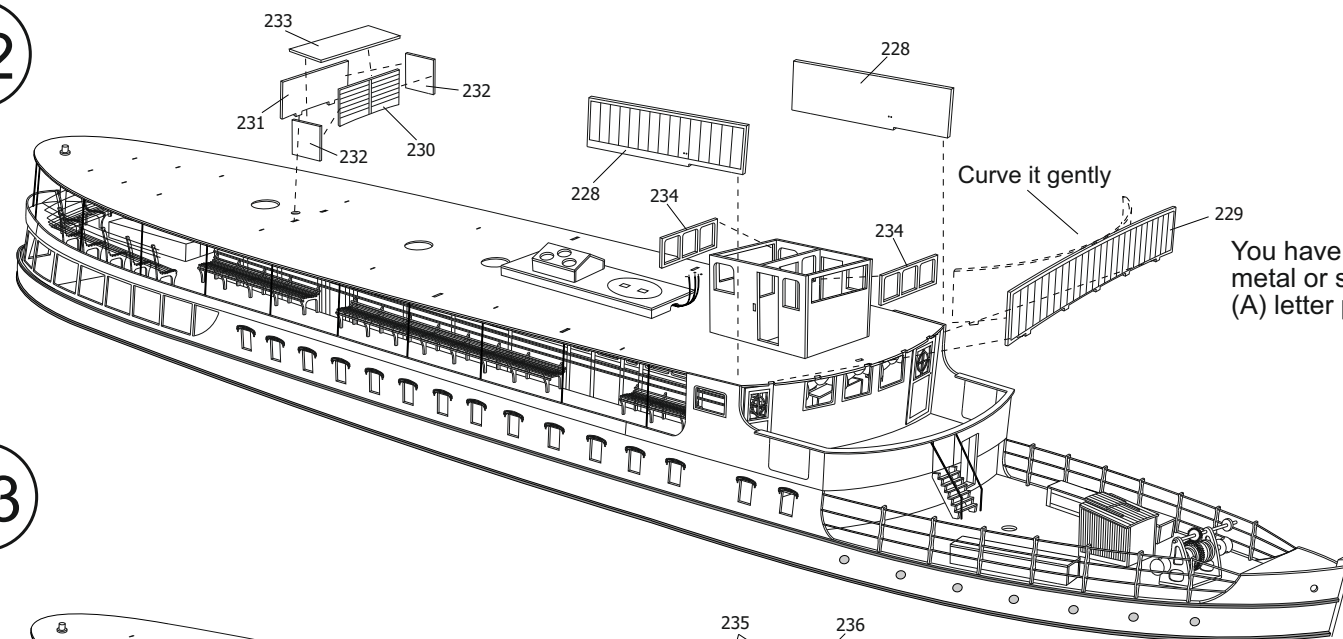

53

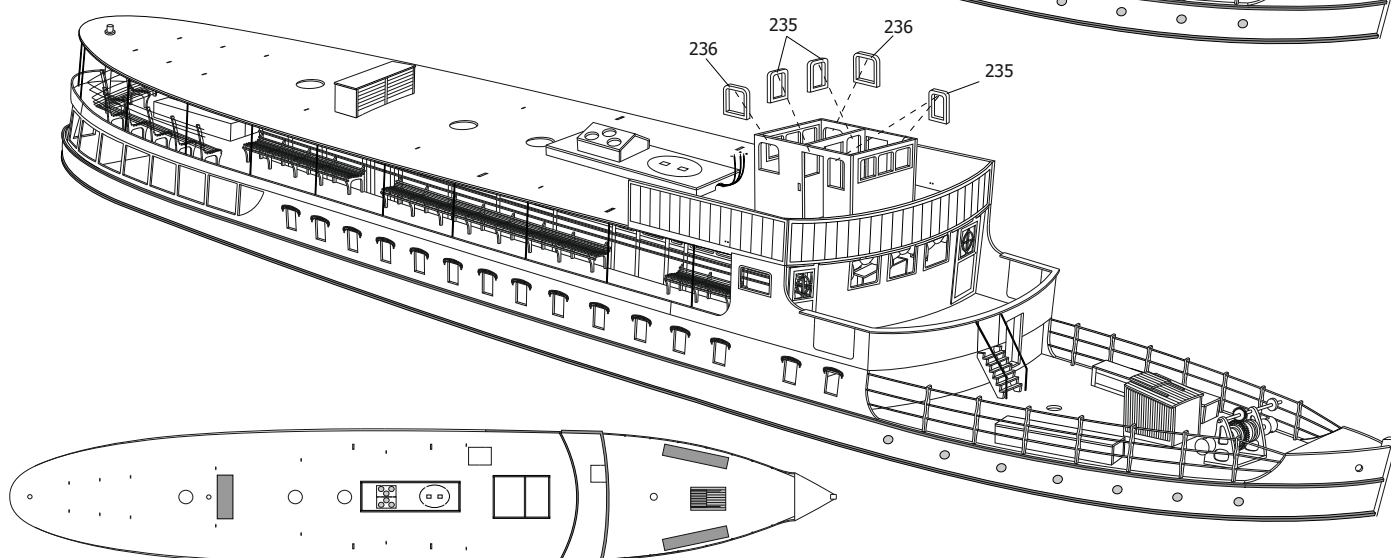

56

WARNING!

You have two options to build funnel either metal or strip cover. If you build as metal, use (A) letter parts, as strip cover use (B) letter parts.

57

Optional

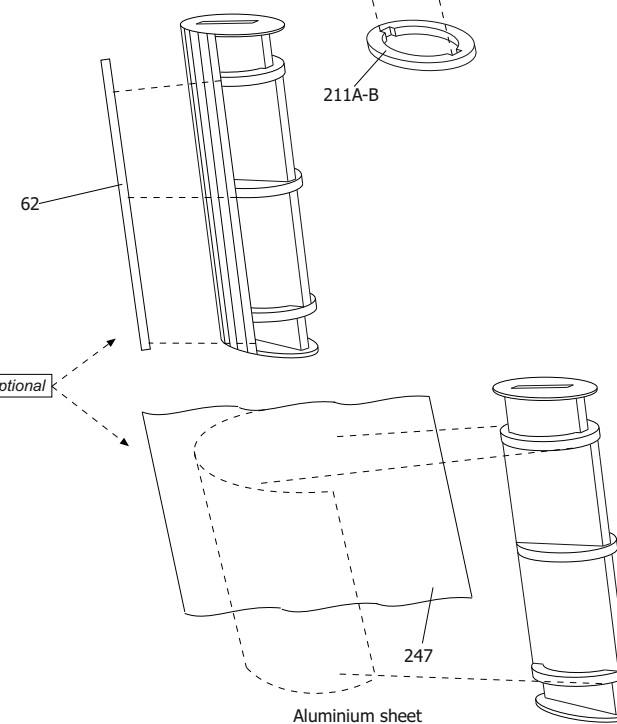

58

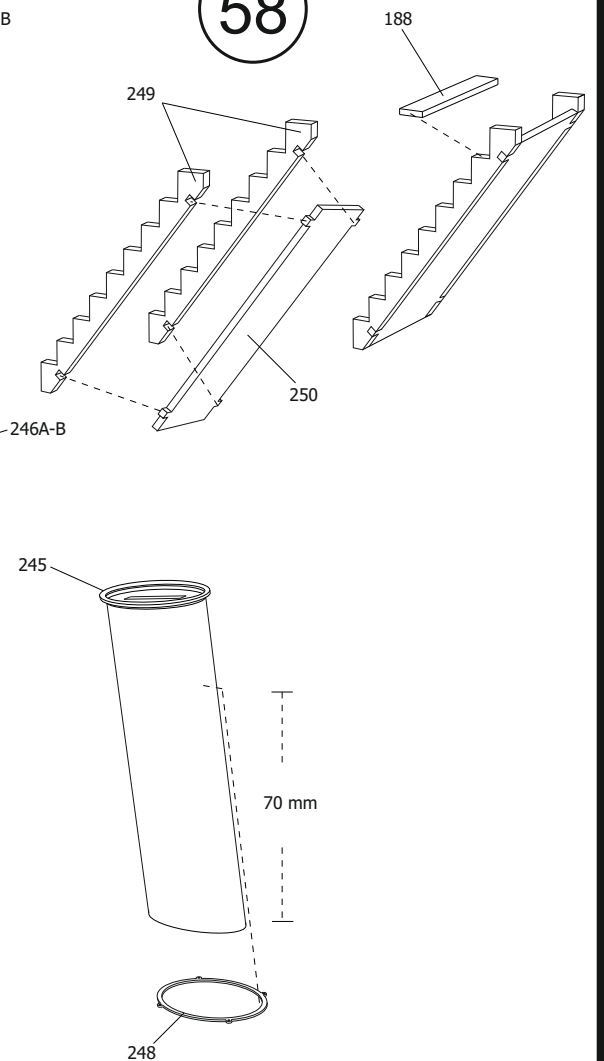

59

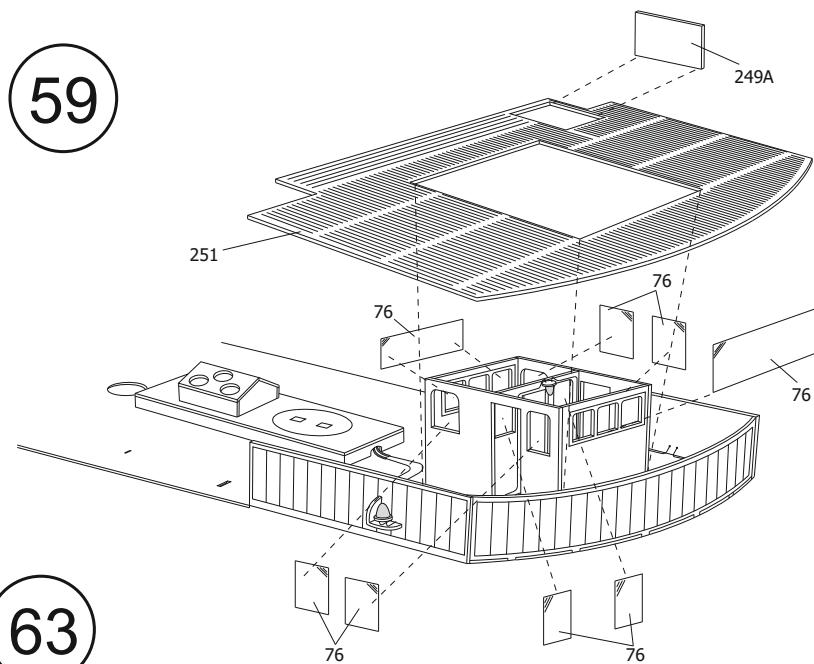

60

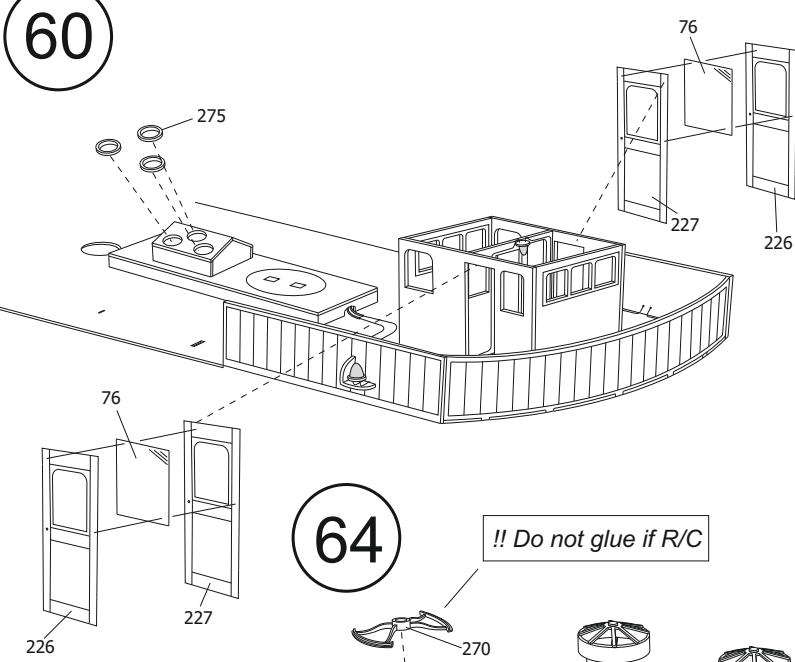

61

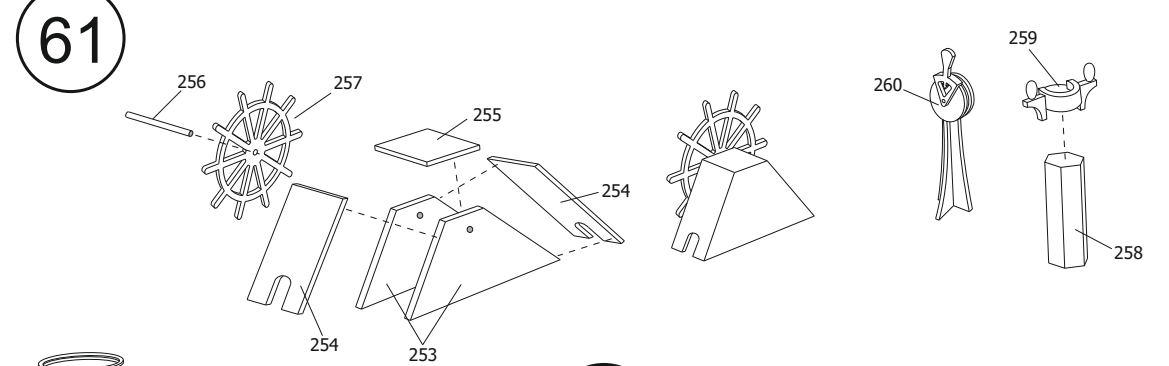

62

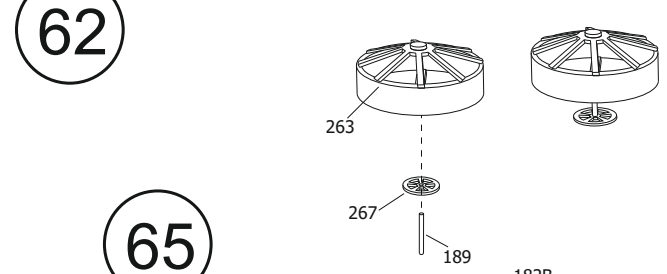

63

Cut the clear sheet suitable size for windows.

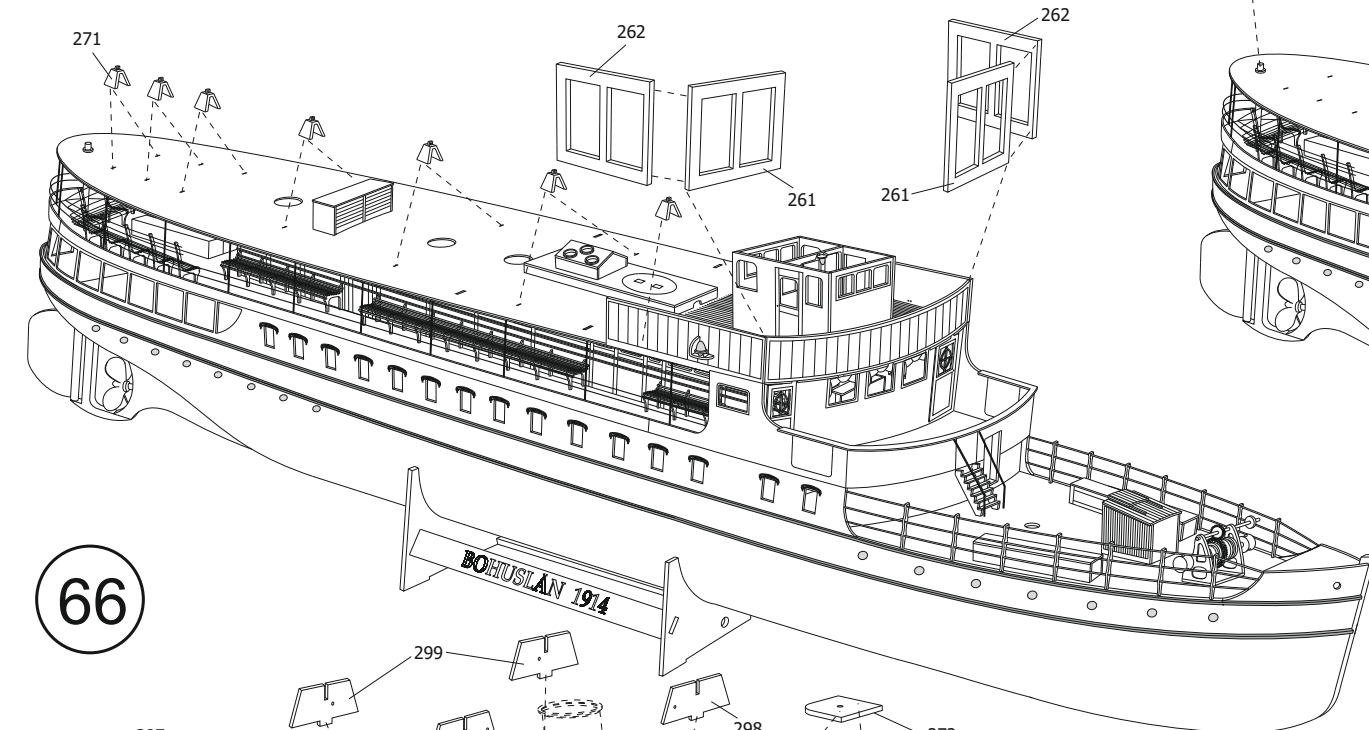

64

!! Do not glue if R/C

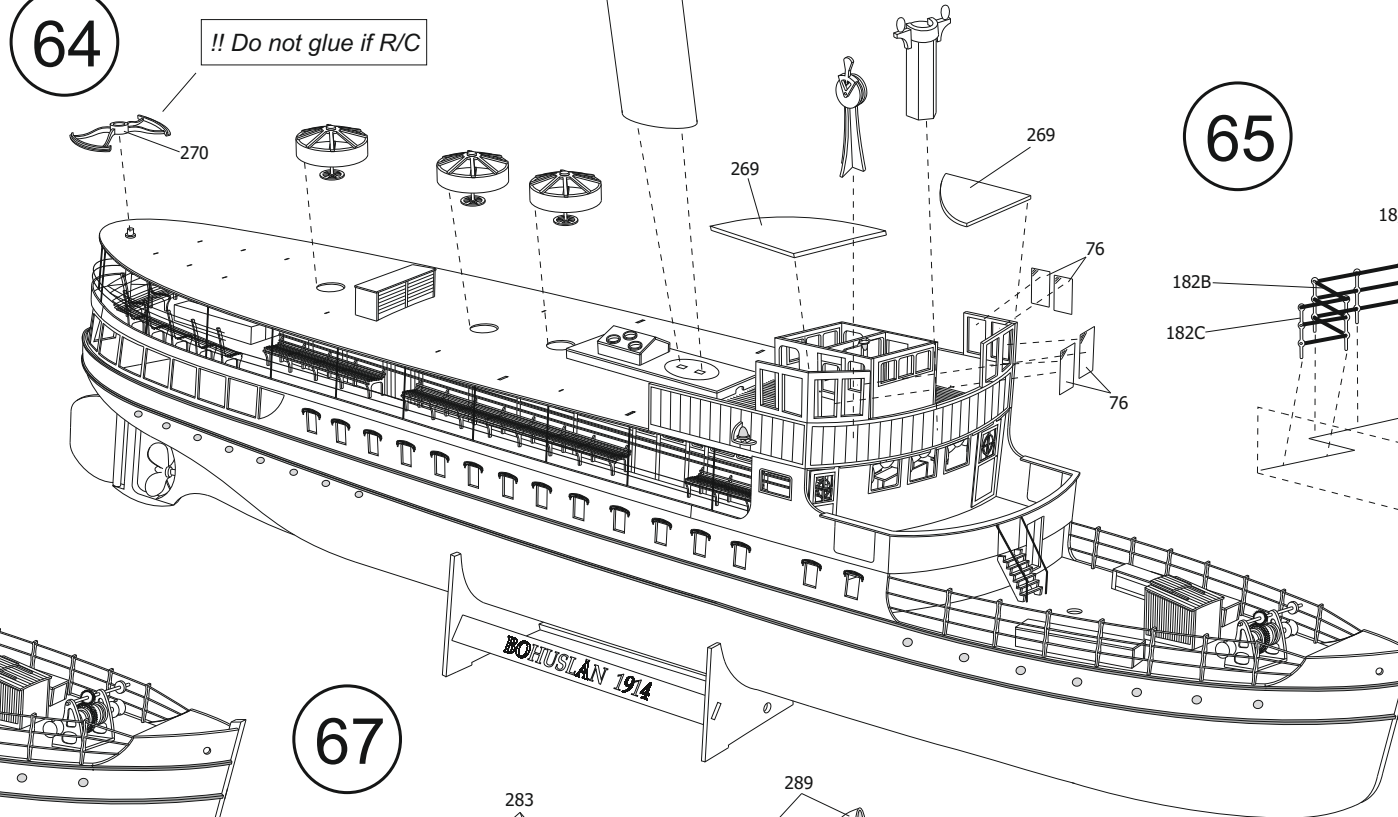

65

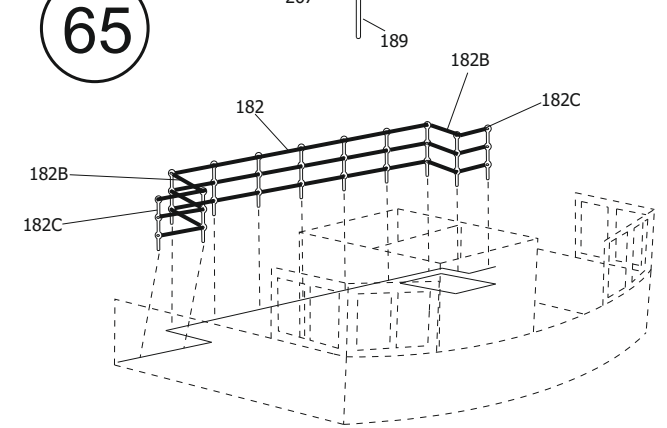

66

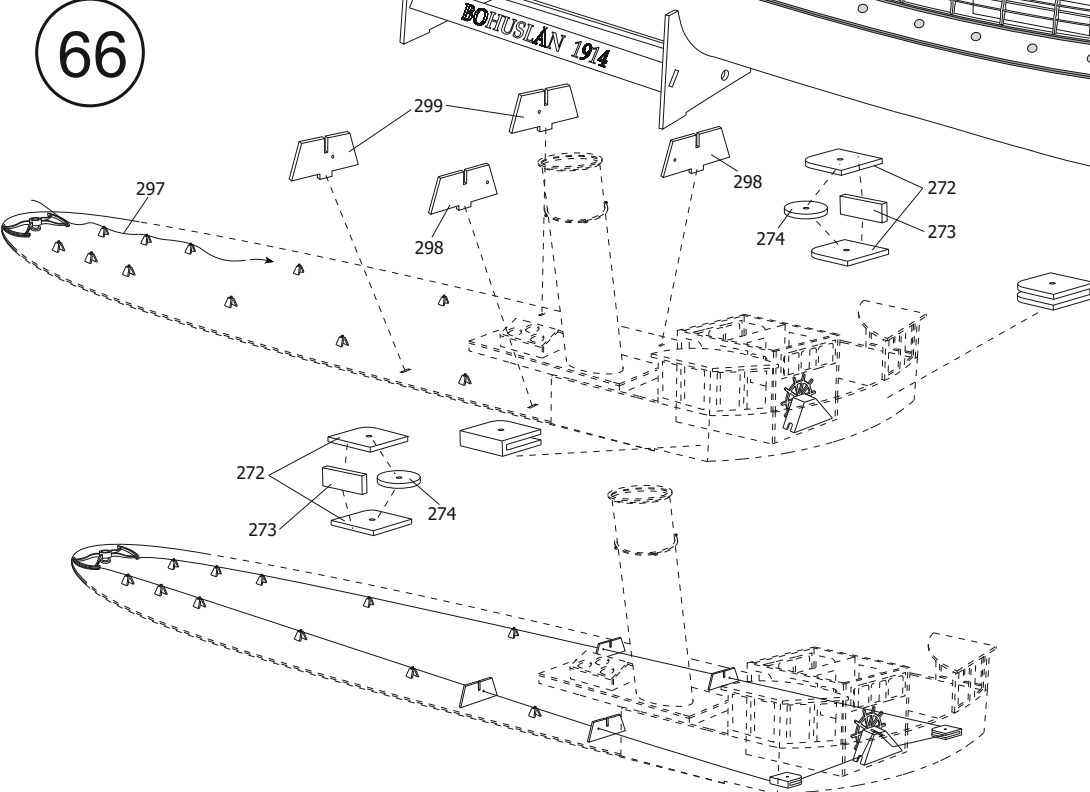

67

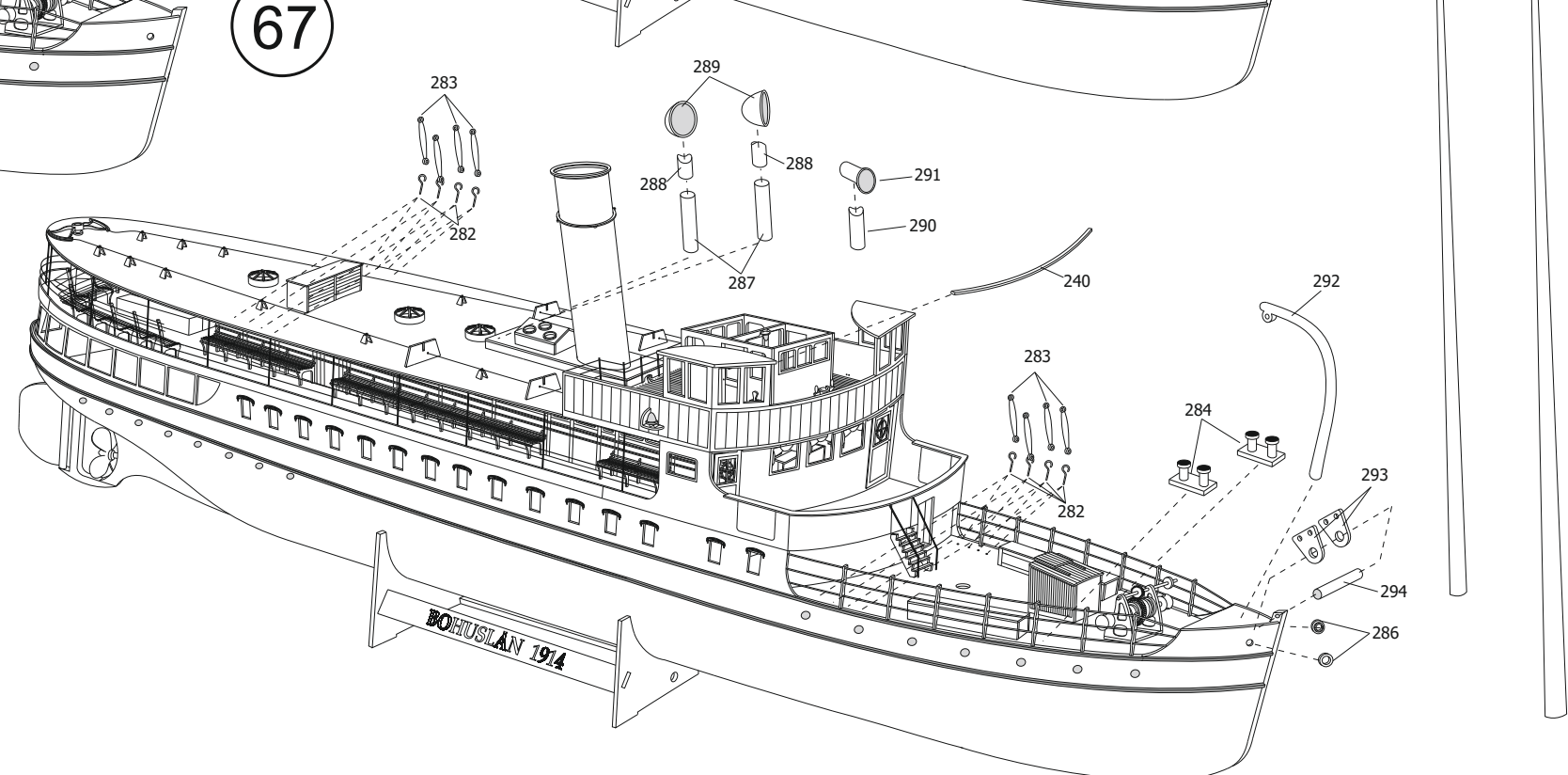

68

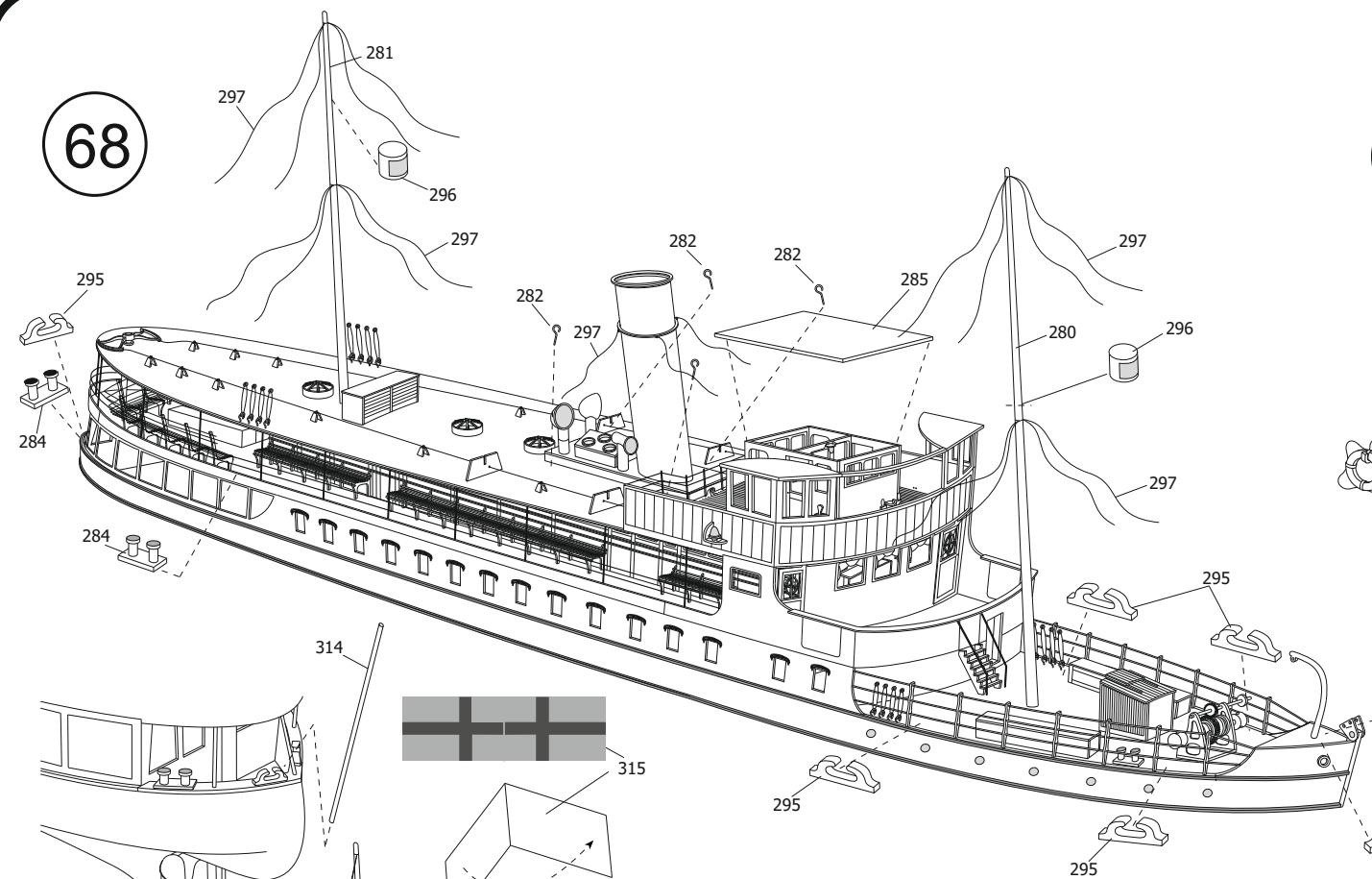

69

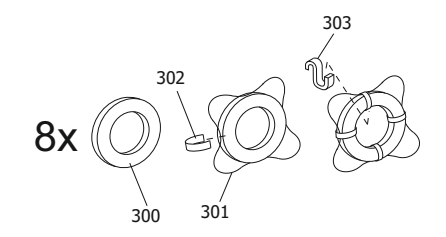
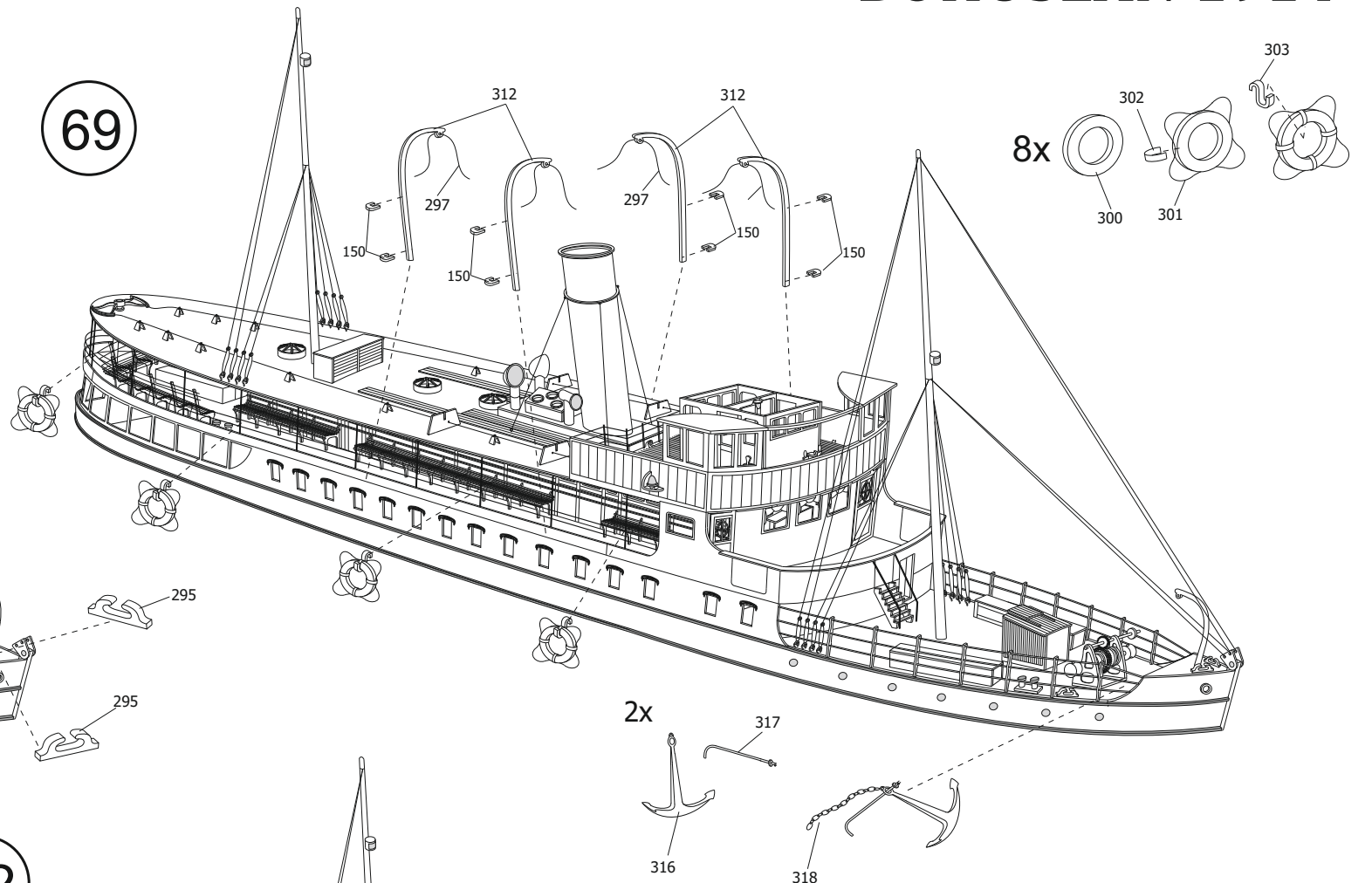

70

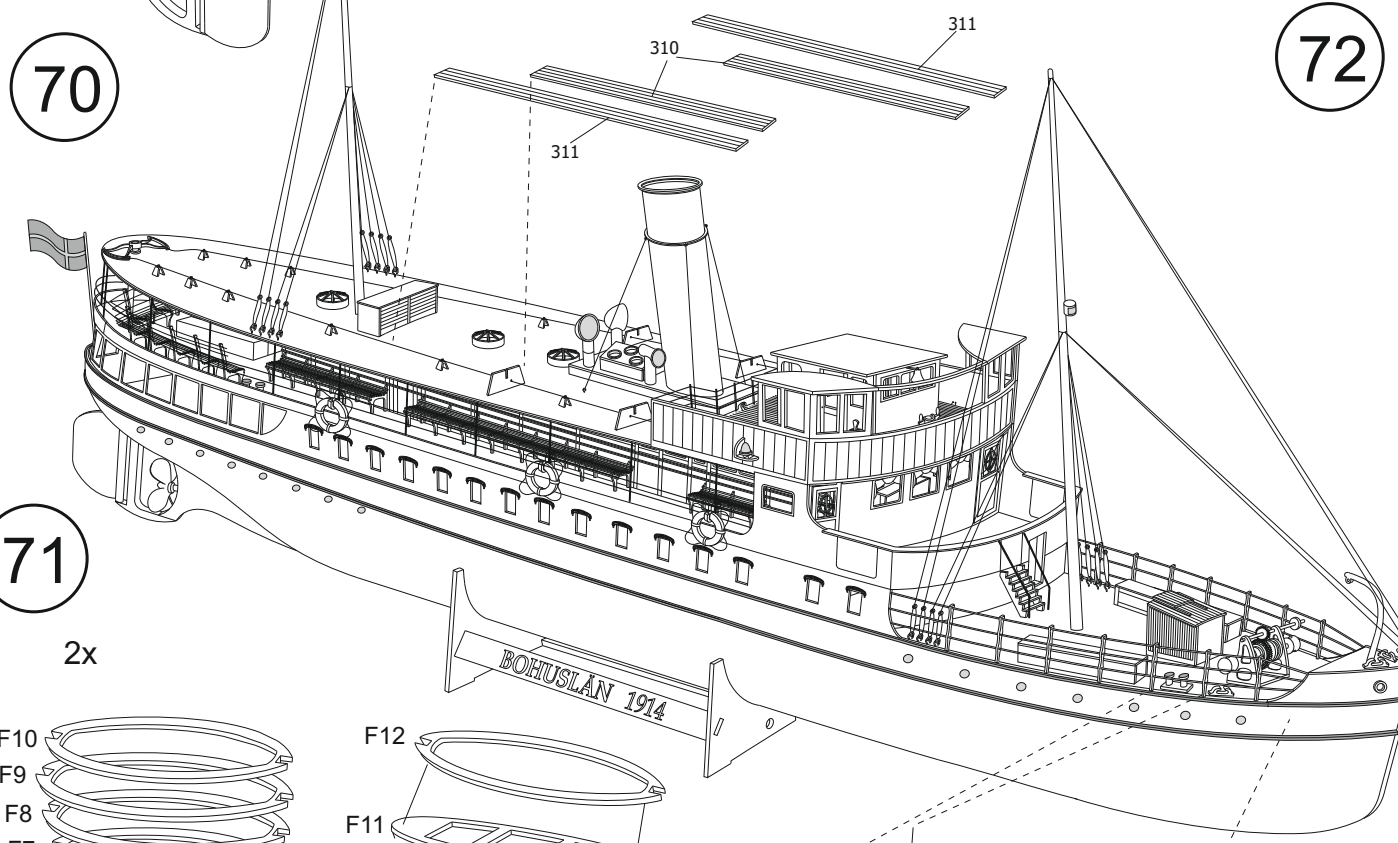

71

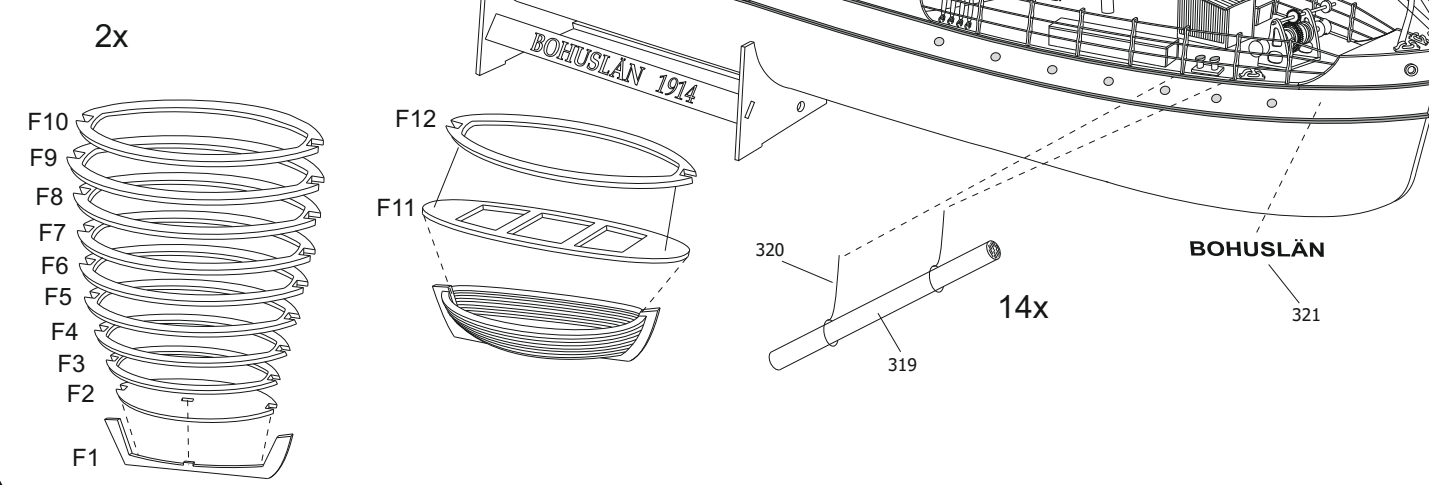

72

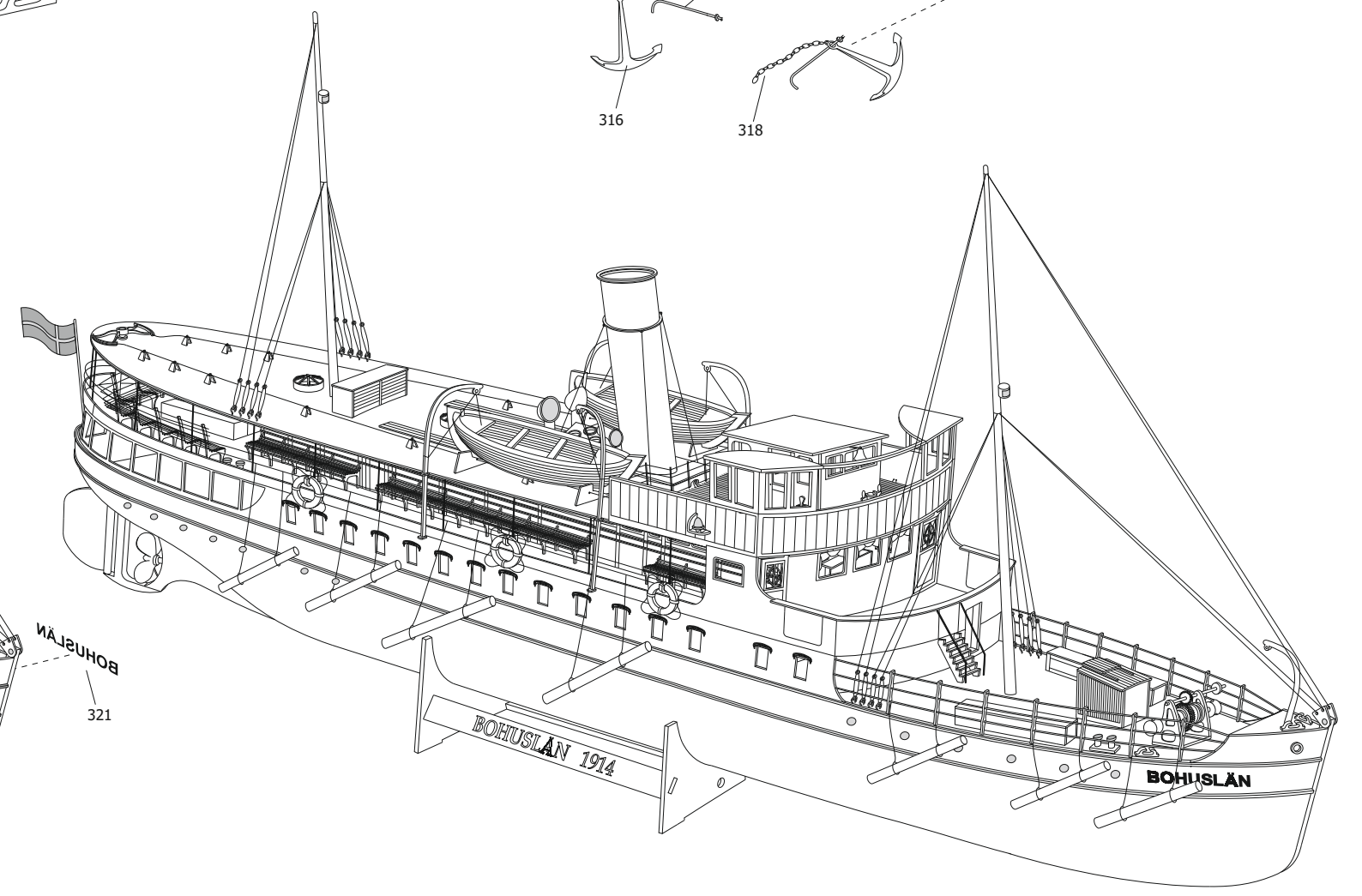

RC1

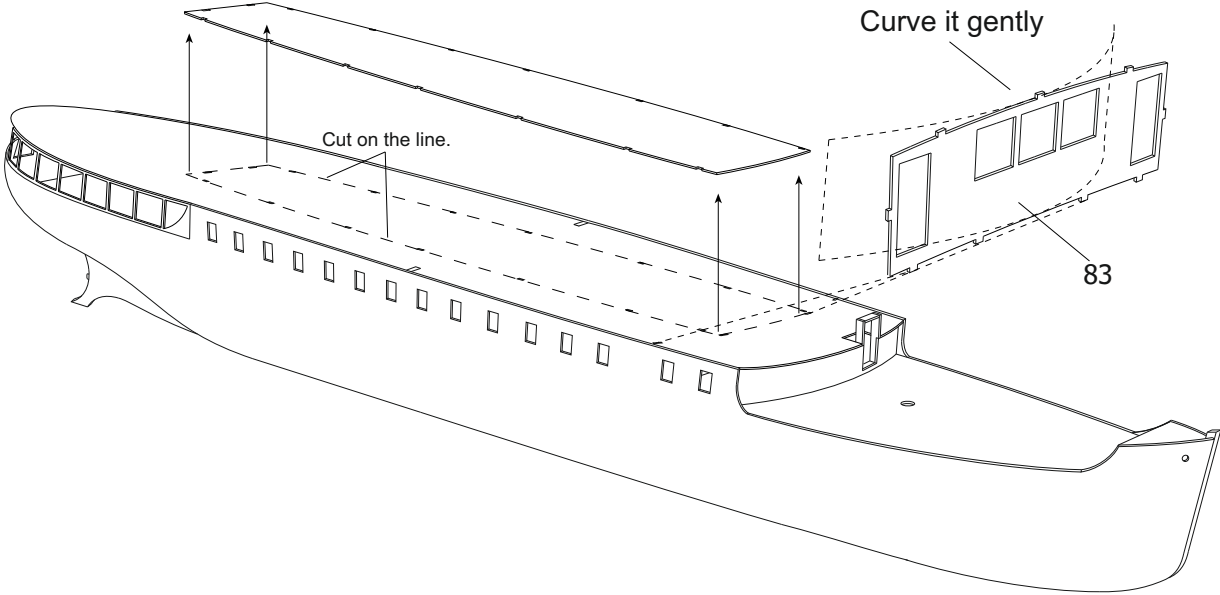

RC2

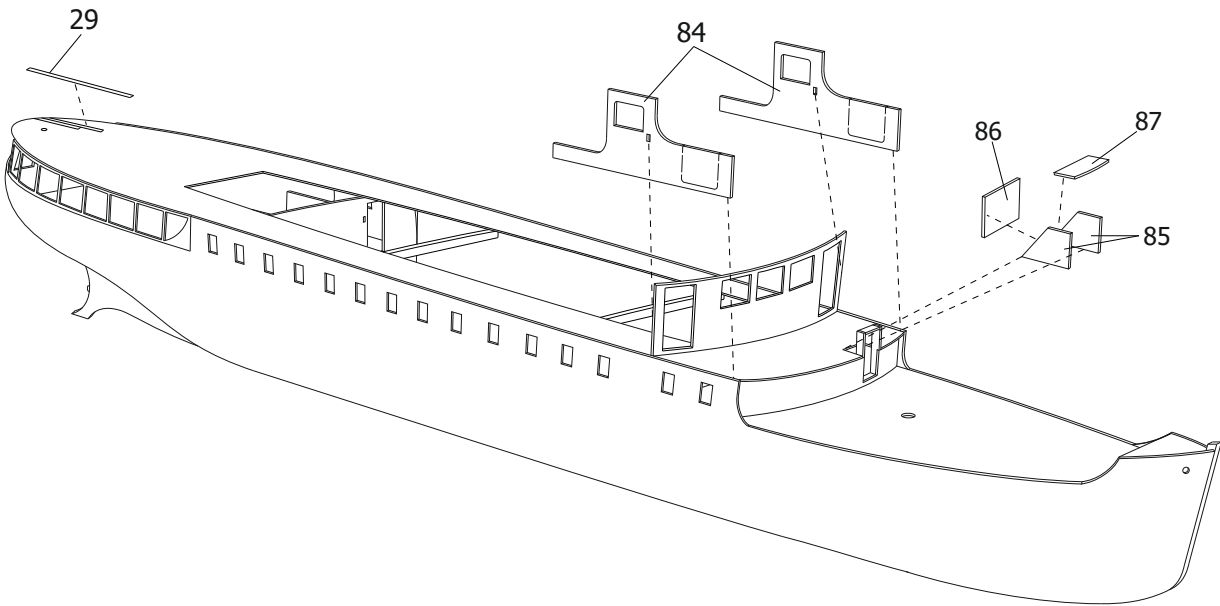

RC3

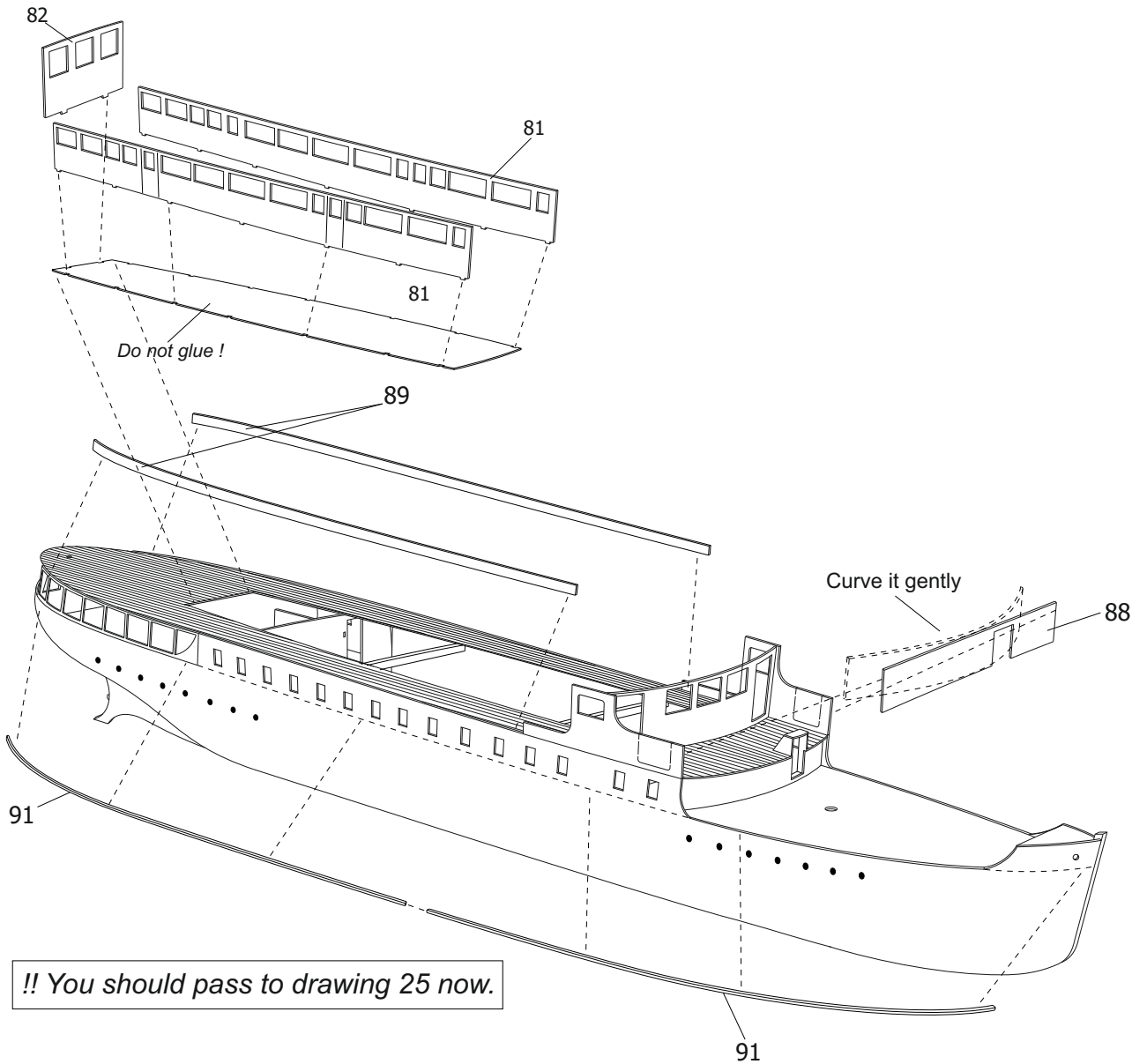

RC4

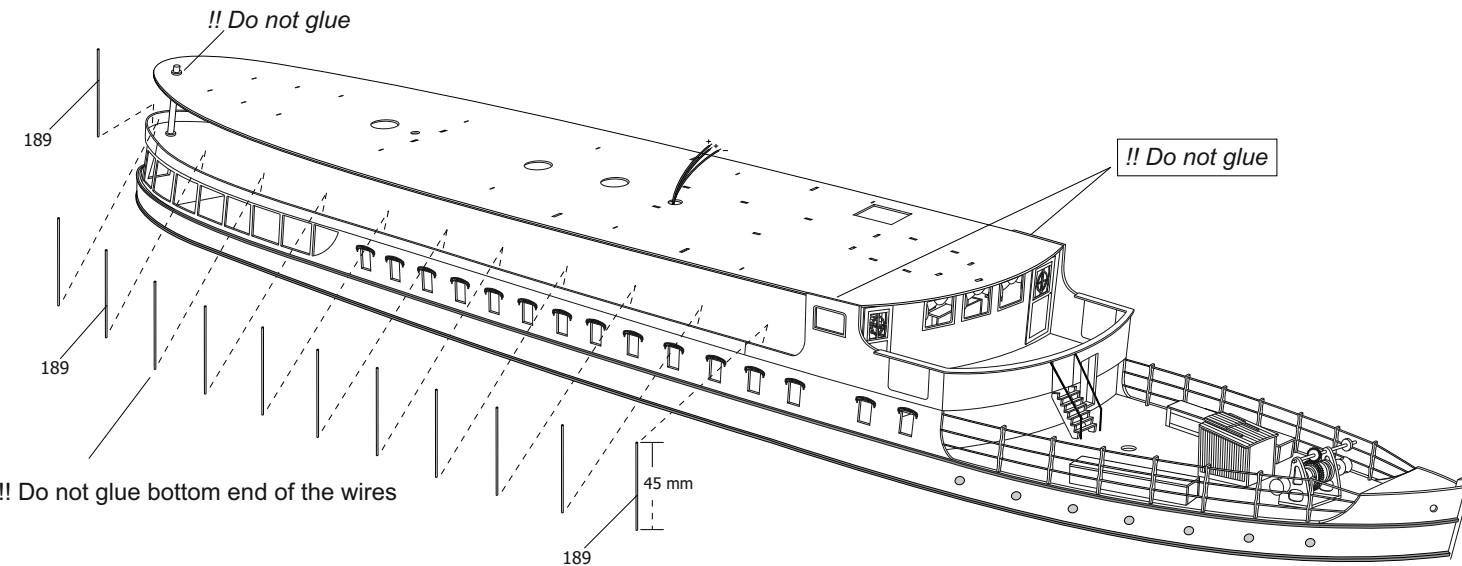

- ❖ Please read the instructions carefully before you start to build your model. Take notes if needed. So, you may find out the materials and the tools those you need.
- ❖ Use model knife to take out the parts the plywood sheets. Do not take them out with hand!
- ❖ Change of temperature effects on plywoods quickly. So that, do not release the plywoods. Keep them on a flat surface by putting weight on them.
- ❖ You may stick together the wooden parts easily if you sand the brown areas caused by laser with sand paper.
- ❖ You should use super glue and white glue to stick together the wooden parts and use the super glue for metal parts.
- ❖ Building the keel of your model, before stick the frames, be sure the frames properly seated on the keel. Otherwise you can't build the body of the model rightly. Exactly be sure that left and right side of the frames are compatible and symmetrical.
- ❖ After building the keel of your model, before the covering, you should test the frame edges by a cover strip. You should sand with a piece of sandpaper the frame edges at the right degree to touch the strips on to the surface exactly. The curves are mostly the front and back side of the body.
- ❖ You should keep the strip tips in the bowl filled with water approximately one hour. So that you may curve the strips on the curves easily these are mostly at the end and the front of the hull.
- ❖ You should cover the strip starting from the top for each side symmetrically.
- ❖ You should cut the upper side of the strip when overlap occurs especially at the front curve of the body.
- ❖ To make equal the surface of the body that caused by planking, you should sand with a piece of sandpaper (Firstly you should use thick sandpaper, then you can apply thin sandpaper), . You should fill the gaps after this processing. You may use leftover strips for wide gaps and model putty for small gaps.
- ❖ If you don't want to appear wooden tissue of the body of your model body; first, apply filler undercoat then sand with a thin sandpaper to make it ready to apply putty. Apply putty whole body and sandpaper again. Apply one more coat filler undercoat and sandpaper. You should not use very thick sandpaper to sand the putty and filler undercoat. You should repeat this process until you get the results as you want. You should apply undercoat paint to find out if any mistake appears at the body. The body gets ready for painting after these applications. You may use model brushes for filler coating. In order to understand whether the materials (such paint, filler, undercoat, varnish, etc.) are compatible with each other, you should test on the unnecessary parts.
- ❖ Some of the model's logo, name or the number are produced from decal paper. You should keep them in a bowl filled with warm water for two or three minutes. You should apply them to their places while releasing from their paper. You may attach easily If you apply gloss varnish to the place before applying the decals. You may apply matt, gloss or satin varnish after this application preferably.
- ❖ You should keep your model away from direct sunlight, heat and moist to avoid deformation in the course of time.

BOHUSLAN PART LIST

www.turkmodel.net

www.facebook.com/turkmodel

Page 1

NO	DESCRIPTION	ITEM	SIZE	TYPE
1-6	Frames	6	4 mm	Plywood
6x	Supporter frames	2	4 mm	Plywood
7-11	Frames	5	4 mm	Plywood
12-13-14	Keel parts	3	4 mm	Plywood
15	Keel bottom part	1	4 mm	Plywood
16-17-18	Measuring parts	6	4 mm	Plywood
19	Front deck	1	1,5 mm	Plywood
20	Back deck	1	1,5 mm	Plywood
21-22	Second deck bottom supporters	3	4 mm	Plywood
23	Side windows panels	2	1,5 mm	Plywood
24	Planking strips	94	1,6x5 mm	Ayous
25	Machine room front part	1	1,5 mm	Plywood
26	Nose deck front part	1	1,5 mm	Plywood
27	Nose side panels	2	1,5 mm	Plywood
28	Propeller shaft pipe	1	5x25 mm	Brass pipe
29	Second plank strips	75	0,5x4 mm	Baswood plank
30-31-32	Machine room door parts	4	1,5 mm	Plywood
33	Machine room back part	1	1,5 mm	Plywood
34...38	Stair parts-up to second deck	6	1,5 mm	Plywood
39	Stair steps	30	0,5 mm	Mahogany sheet
40-41-42	Desk parts	5	1,5 mm	Plywood
43	Back cabine seat leg parts	12	1,5 mm	Plywood
44-45-46	Seats base	3	1,5 mm	Plywood
47	Kitchen wall	1	1,5 mm	Plywood
48...52	Seat cushions	20	0,5 mm	Mahogany sheet
53	Desk side door	1	1,5 mm	Plywood
54-55-56	Kitchen bottom cabinet doors	3	1,5 mm	Plywood
57-58-60	Sink parts	5	1,5 mm	Plywood
59	Kitchen bottom cabinet side door	1	1,5 mm	Plywood
61	Kitchen counter	1	1,5 mm	Plywood
62	Funnel cover strips	15	1,5x4 mm	Baswood
64-65-66	Table parts	54	0,5 mm	Mahogany sheet
67-68-69	Chair parts	117	0,5 mm	Mahogany sheet
70-71	Rudder and its connector part	2	4 mm	Plywood
72	Back cabine and its front door parts (without glass)	3	0,5 mm	Mahogany sheet
73	Back cabine windows panels	2	1,5 mm	Plywood
74	Back cabine back part	1	1,5 mm	Plywood
75	Second deck	1	1,5 mm	Plywood
76	Side window glasses	-	-	Clear sheet
77...80	Back cabine glasses	20	1 mm	Plexy-glass
81	Second deck main cabine side parts	2	1,5 mm	Plywood
82	Main cabine back part	1	1,5 mm	Plywood
83	Main cabine front part	1	1,5 mm	Plywood
84	Main cabine side panels	2	1,5 mm	Plywood
85-86-87	Stair space	4	1,5 mm	Plywood
88	Main cabine front panel	1	1,5 mm	Plywood
89-90	Second deck side panel additions	3	1,5 mm	Plywood
91	Laths	8	1,5x1,5 mm	Baswood
92...97	Main cabine side frames	26	1,5 mm	Plywood

NO	DESCRIPTION	ITEM	SIZE	TYPE
105	Main cabine back frames	3	1,5 mm	Plywood
106	Main cabine front frames	3	1,5 mm	Plywood
107	Main cabine side frames	2	1,5 mm	Plywood
110-111-112	Main cabine seperator walls	3	1,5 mm	Plywood
113	Second deck back cabine seat leg parts	13	1,5 mm	Plywood
114	Main cabine outside seat legs	37	1,5 mm	Plywood
115	Strips	28	1x1 mm	Baswood
116	Single door with glass	6	0,5 mm	Mahogany sheet
117	Single door with glass	6	0,5 mm	Mahogany sheet
118	Double doors with glass	1	0,5 mm	Mahogany sheet
120...123	Main deck seat parts - double seats	24	1,5 mm	Plywood
124-125	Table and its legs	24	1,5 mm	Plywood
126...129	Main deck seat parts - single seats	20	1,5 mm	Plywood
130	Funnel space side parts (in the cabine)	2	1,5 mm	Plywood
131...136	Cabinet parts in the cabine	9	1,5 mm	Plywood
137...142	Women cabine seat parts	9	1,5 mm	Plywood
140C...143C	Base plate parts	5	4 mm	Plywood
143-144-145	Women cabine table parts	4	1,5 mm	Plywood
146	Main cabine front balcony rail	1	1,5 mm	Plywood
148-149	Table and its legs	3	1,5 mm	Plywood
150	Lifeboat hanger fixers	8	Ready to use	Plexy-glass
161...167	Main cabine curtains	24	Ready to use	Fabric
169...174	Back outdoor life ring cabinet parts	13	1,5 mm	Plywood
176...181	Front deck enter of the lazaret parts	8	1,5 mm	Plywood
182-A-B-C	Guardrails	7	1 mm	PVC
183	Guardrail wire	-	0,4 mm	Wire
184...186	Front deck chest parts	10	1,5 mm	Plywood
187	Fornt stair	2	1,5 mm	Plywood
188	Stair step strips	1	1x4 mm	Baswood
189	Wire	-	0,8x1000 mm	Wire
190	Upper deck	1	1,5 mm	Plywood
192-193	Upper deck support bars guide	3	1,5 mm	Plywood
194	Winch bottom	1	1 mm	Plexy-glass
195	Winch side parts	2	-	White metal
196	Winch shaft	1	2x33 mm	Wire
197	Winch main gear	1	-	White metal
198-199-200	Winch gears	10	1 mm	Plexy-glass
201	Winch shaft	1	1,5x33 mm	Wire
202	Winch gear	1	1 mm	Plexy-glass
203	Winch heads	2	-	White metal
204	Bell	1	-	White metal
205	Propeller	1	-	White metal
206	Rudder shaft	1	5x190 mm	Wire
207	Rudder shaft fixer ring	3	1 mm	Plexy-glass
208	Back bulwark part	1	1,5 mm	Plywood
210A-B	Funnel main part (optional)	1	4 mm	Plywood
211A-B,212A-B	Funnel constrction parts (optional)	3	4 mm	Plywood
213...217	Captain cabine parts	5	1,5 mm	Plywood
218...222	Funnel cabine parts	5	1,5 mm	Plywood
223...225	Ventilation cabine parts	6	1,5 mm	Plywood
226	Captain cabine doors	2	0,5 mm	Mahogany sheet
227	Captain cabine doors	2	0,5 mm	Mahogany sheet
228	Captain cabine side parts	2	1,5 mm	Plywood
229	Captain cabine front part	1	1,5 mm	Plywood

NO	DESCRIPTION	ITEM	SIZE	TYPE
230...233	Upper deck chest parts	5	1,5 mm	Plywood
234-235-236	Captain cabine frames	8	1,5 mm	Plywood
237	Middle deck stair space parts	2	1,5 mm	Plywood
238A-238B-239	Middle deck stair space parts	3	1,5 mm	Plywood
240	Captain cabine front finge part	1	1,5 mm	Plywood
241-242-243	Back post base parts	3	1,5 mm	Plywood
244A-B	Funnel lid bottom (optional)	1	1,5 mm	Plywood
245	Funnel lid (optional also 1,5 mm plywood)	1	1 mm	Plexy-glass
246A-B	Funnel bottom (optional)	1	1,5 mm	Plywood
247	Funnel planking material	1	0,3 mm	Aluminium Foil
248	Funnel ring	1	-	White metal
249	Stair side parts	2	1,5 mm	Plywood
249A	Door to captain balcony	1	1 mm	Plexy-glass
250	Stair base part	1	1,5 mm	Plywood
251	Captain cabine floor grill	1	1,5 mm	Plywood
252	Board light keeper (right-left)	2	-	White metal
253-254-255	Rudder wheel cabinet parts	5	1,5 mm	Plywood
256	Rudder wheel shaft	1	1 mm	Wire
257	Rudder wheel	1	-	White metal
258	Compass stand	1	Ready to use	Mahogany
259	Compass	1	-	White metal
260	Telegraph	1	-	White metal
261-262	Captain cabine side balcony parts	4	1,5 mm	Plywood
263	Sunroof	3	Ready to use	3D print-out
267	Sunroof opener part	3	1 mm	Plexy-glass
269	Side balcony roof parts	2	1,5 mm	Plywood
270	Rudder control part	1	-	White metal
271	Rudder control wire fixer parts	14	-	White metal
272-273-274	Rudder control wire reel	8	1 mm	Plexy-glass
275	Ventilation windows	6	-	White metal
280	Front post	1	8 mm	Dovel strip
281	Back post	1	6 mm	Dovel strip
282	Eyebolt	20	-	Metal
283	Chain plate	16	-	White metal
284	Double head bollards	6	-	White metal
285	Captain cabine roof	1	1,5 mm	Plywood
286	Front ports	2	-	White metal
287	Large ventilation stands	2	5x13 mm	Metal
288-289	Large ventilation parts	4	-	White metal
290-291	Small ventilation	2	-	White metal
292	Nose hanger	1	-	White metal
293	Nose rope fastening part	2	1 mm	Plexy-glass
294	Nose rope fastening part shaft	1	1,5x10 mm	Wire
295	Fairlead	8	-	White metal
296	Post light	3	-	3D print-out
297	Rope	-	-	Rope
298-299	Lifeboat base plate parts	4	1,5 mm	Plywood
300	Liferings	8	-	White metal
301	Rope for liferings	-	-	White rope
302	Lifering belts	-	-	Stickers
303	Lifering hangers	8	-	Plexy-glass
304...309	Resistances box parts	7	1,5 mm	Plywood
310-311	Floor grill parts	4	1,5 mm	Plywood
312	Lifeboat hangers	4	2 mm	Plexy-glass
314	Flag post	1	2 mm	Brass wire
315	Flag	1	-	Sticker
316	Anchors	2		White metal
317	Anchor bars	2		White metal
318	Chain	1	50 cm	Metal
319	Boarding supporters	14	4x60 mm	Dovel strip
320	Boarding supporters rope	1	2000 mm	Waxed rope
321	Ship name	2	-	Decals
F1...F12	Lifeboat parts	24	1,5 mm	Plywood